

**Please attach UPS Return Label here:**

A large, empty rectangular box with rounded corners, intended for attaching a UPS Return Label. The box is outlined in black and occupies the central portion of the page.

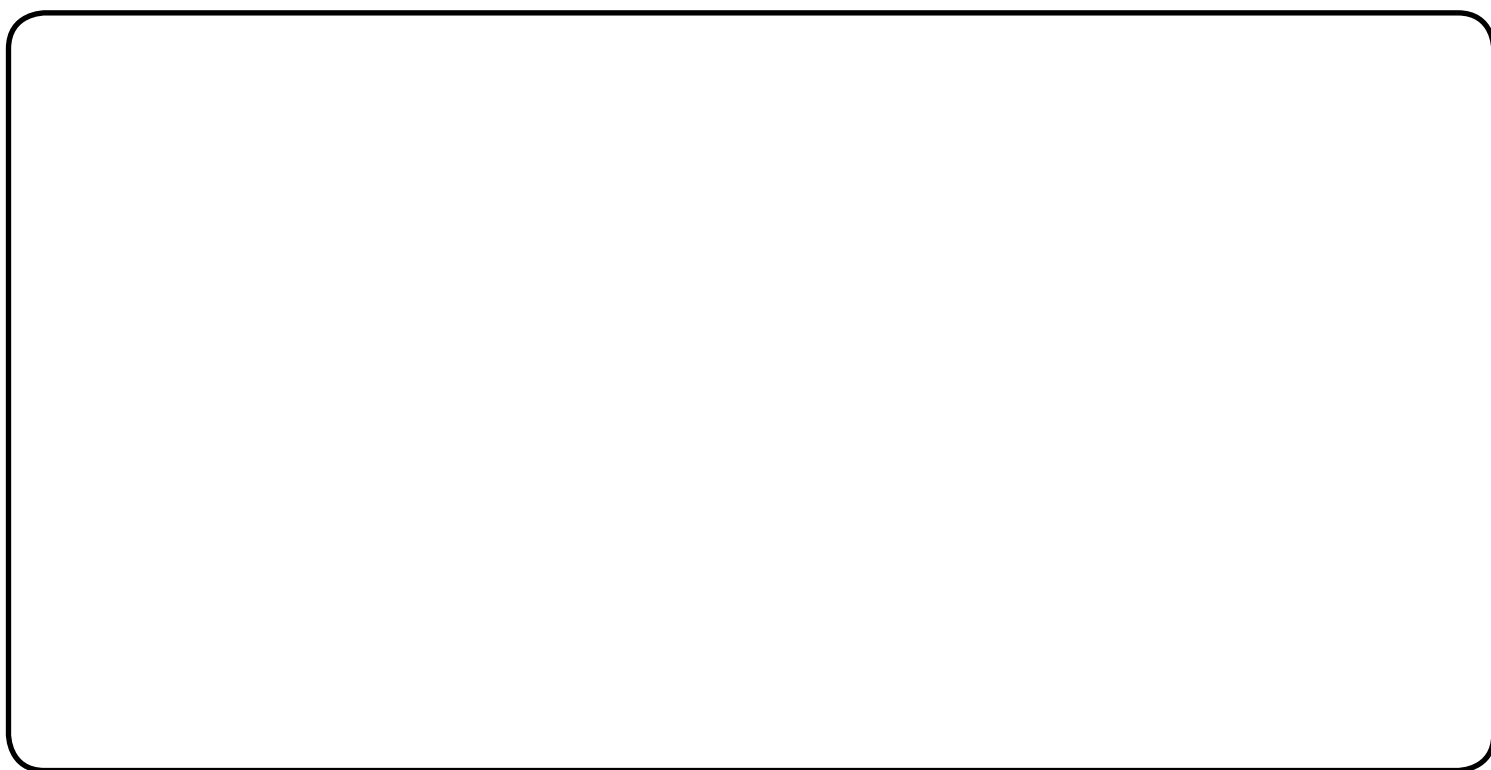

## INSTALLATION INSTRUCTIONS

### Honda Rincon 680 Power Steering

| Item | Description                     | Qty |
|------|---------------------------------|-----|
| A    | M8-1.25 x 20mm Lg. FHCS         | 3   |
| B    | Support Bracket                 | 1   |
| C    | M6-1.0 x 16mm Lg. HHCS          | 2   |
| D    | M6-1.0 x 20mm Lg. FHCS          | 3   |
| E    | M8 Flat Washers                 | 2   |
| F    | M6-1.0 Nylock Nuts, Flange      | 3   |
| G    | Upper Shaft                     | 1   |
| H    | Lower Shaft                     | 1   |
| J    | Control Module                  | 1   |
| K    | Motor                           | 1   |
| L    | Wiring Harness                  | 1   |
| M    | Wiring Connectors Kit           | 1   |
| N    | Mounting Bracket                | 1   |
| P    | Control Module Mounting Bracket | 1   |
| Q    | M10-1.50 x 30mm Lg. HHCS        | 1   |
| R    | M10 Flat Washers                | 2   |
| S    | M10-1.50 Nylock Nut             | 1   |
| T    | M8-1.25 Nylock Nuts, Flange     | 3   |
| U    | Mounting Bracket Support        | 1   |
| V    | M8-1.25 x 25mm Lg. FHCS         | 3   |

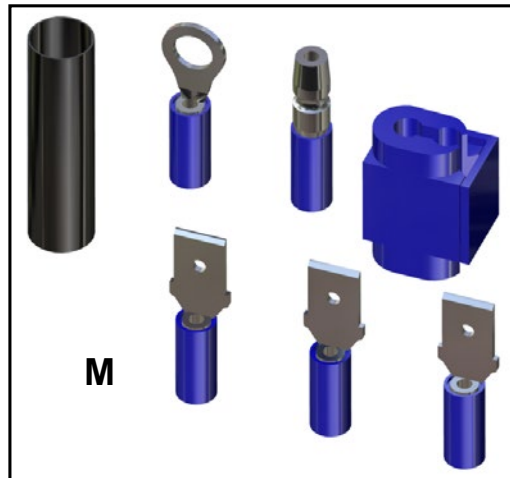
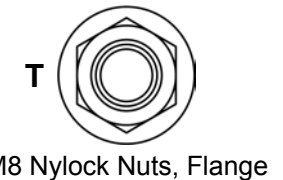
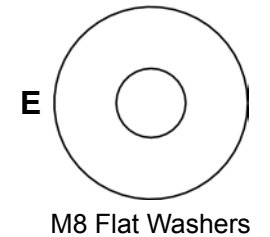
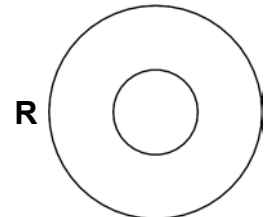
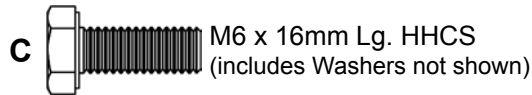

(Kit contents continue on following page)

Read instructions and view illustrations before beginning.

Need help with your installation?

sales@superatv.com www.superatv.com

1-812-574-7777 8:00am - 9:00pm EST M-Th  
8:00am - 7:00pm EST Friday  
9:00am - 2:00pm EST Saturday

Thank You  
For Choosing

#### Liability Statement

SuperATV's products are designed to best fit users ATV/UTV under stock conditions. Adding, modifying, or fabricating any factory, or aftermarket, parts will void any warranty provided by SuperATV and is not recommended. SuperATV's products could interfere with other aftermarket accessories. If user has aftermarket products on machine, contact SuperATV to verify that they will work together.

Although SuperATV has thousands of satisfied customers, user should be aware that installing lift kits, long travel, or suspension kits, tires, etc will change the ride of machine and may increase maintenance and part wear. Operating any off-road machine while, or after, consuming alcohol and/or drugs increases risk of bodily harm or death. No warranty or representation is made as to this product's ability to protect user from severe injury or death. SuperATV urges operators and occupants to wear a helmet and appropriate riding gear at all times.

By purchasing and installing SuperATV products, user agrees that should damages occur, SuperATV will not be held responsible for loss of time, use, labor fees, replacement parts, or freight charges. SuperATV, nor any 3rd party, will not be held responsible for any direct, indirect, incidental, special, or consequential damages that result from any product purchased from SuperATV. The total liability of seller to user for all damages, losses, and causes of action, if any, shall not exceed the total purchase price paid for the product that gave rise to the claim.

SuperATV will warranty only parts provided by SuperATV. Any damage or problems with OEM housings, bearings, seals, or other manufacturers products will not be covered by SuperATV. SuperATV parts and products are not warranted if item was not installed properly, misused, or modified.

| Item | Description                     | Qty |
|------|---------------------------------|-----|
| B    | Support Bracket                 | 1   |
| G    | Upper Shaft                     | 1   |
| H    | Lower Shaft                     | 1   |
| J    | Control Module                  | 1   |
| K    | Motor                           | 1   |
| L    | Wiring Harness                  | 1   |
| N    | Mounting Bracket                | 1   |
| P    | Control Module Mounting Bracket | 1   |
| U    | Mounting Bracket Support        | 1   |

(Kit contents continued)

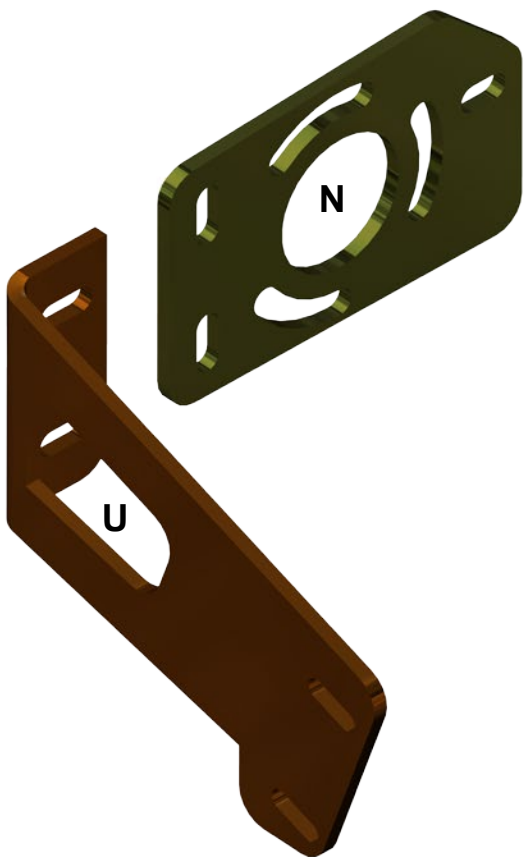
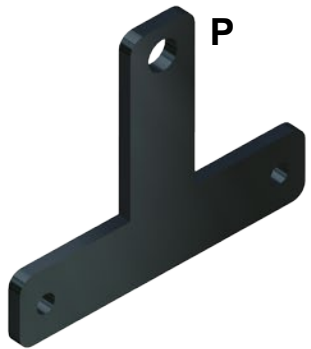
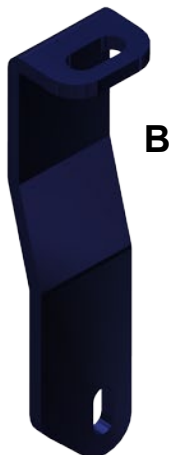
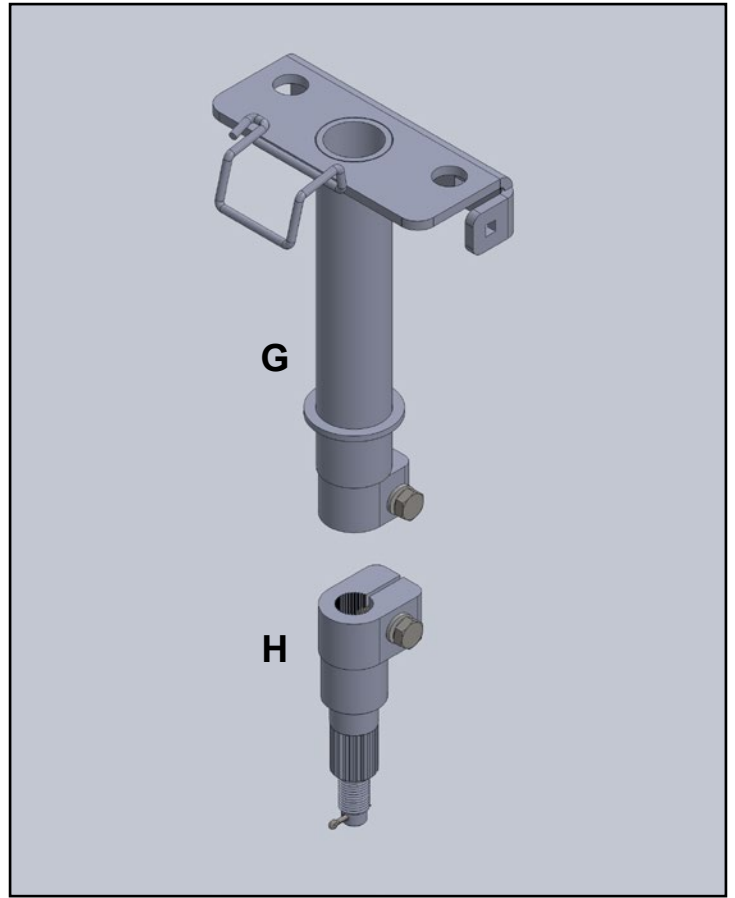



Power Steering will provide multiple improvements to your machine. After installation, it is highly recommend to take time and learn your machines new handling characteristics and feel.

Key Recommendations:

1. Power Steering Benefits will be noticed as soon as machine is moving.
2. Handlebar will have more noticeable deflection while at rest. As a result of speed sensitive operation, this is normal.
3. Check steering sensitivity at multiple speeds to best understand new handling characteristics and feel.
4. Without Throttle input, turning Handlebar back and forth unnecessarily is not recommended. This action is very hard on remaining stock steering components, Tie Rod Ends, and Power Steering unit.

Like all SuperATV products, Power Steering kits were designed with riders in mind.

## Connections

- Before installing, ensure that all waterproof connections are properly seated.
- If Gaskets are not seated, as shown, use a Flathead Screwdriver to seat.

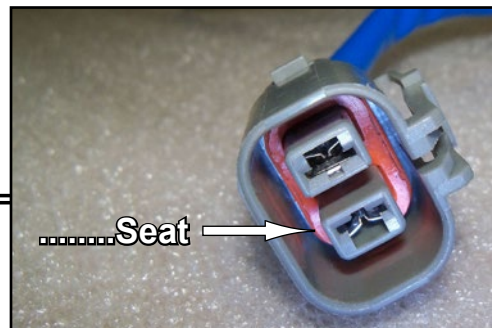
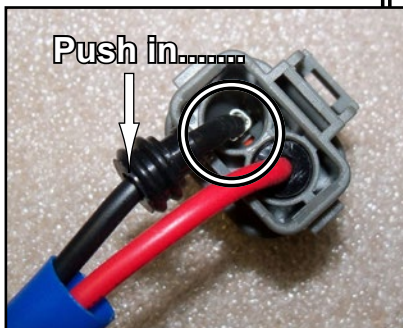
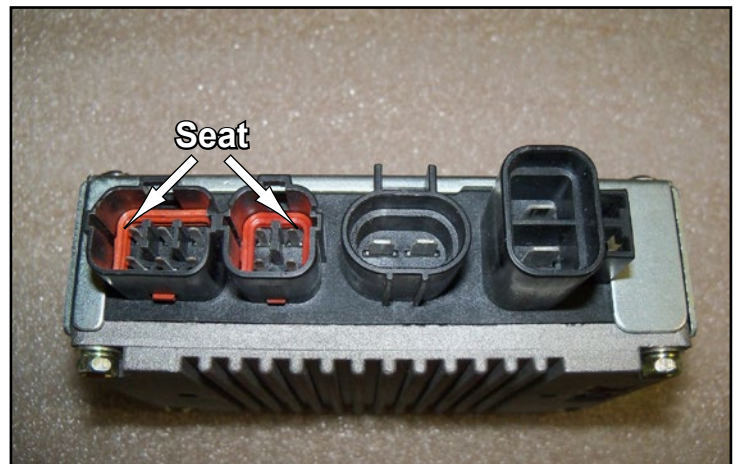
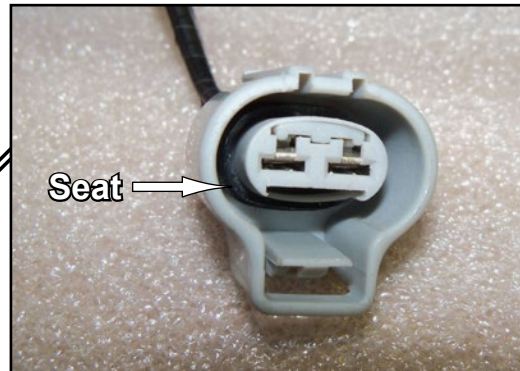



**For reference, photographing of removal process is highly recommended due to amount of components being removed from machine.**

**Removal: Keep all stock hardware removed from machine.**

1. Raise front of machine, secure with jack stands; remove Wheels and Seat.
2. If applicable, Remove Bumper. See Fig. 1.
3. Remove Fender Braces and Inner Fenders from both sides. See Fig. 2.
4. Remove Front Fender. See Fig. 3.
5. Remove Covers from around Gas Tank as shown in Fig. 4.
6. Remove Side Panels. See Fig. 5.
7. Remove Upper and Lower Covers from Handlebar. See Figs. 6 - 6a.
8. Remove Utility Box. See Fig. 7.
9. Remove Tie Rods from Steering Arm. See Fig. 8.
10. Remove Castle Nut and Pin from Steering Shaft. See Fig. 8.
11. Remove Washers and Nuts from Handlebar Holders. Lay Handlebar out of way. See Fig. 9.
12. From top of machine pull Steering Shaft out.

*(Removal illustrations on following pages)*



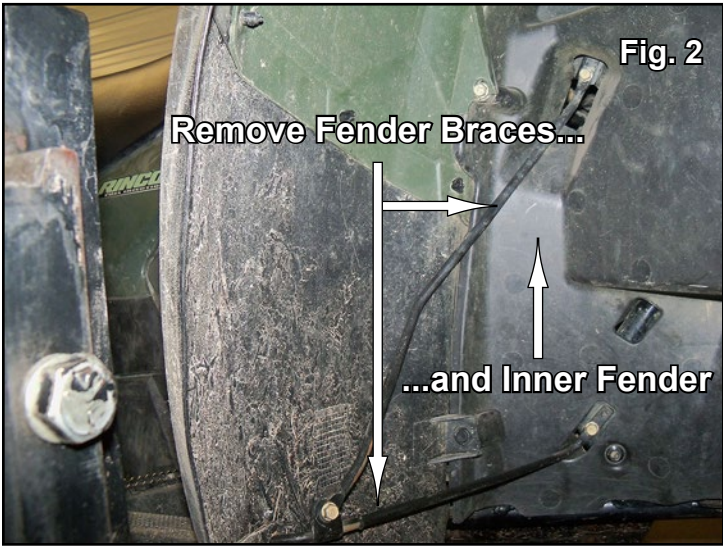

(Removal illustrations)

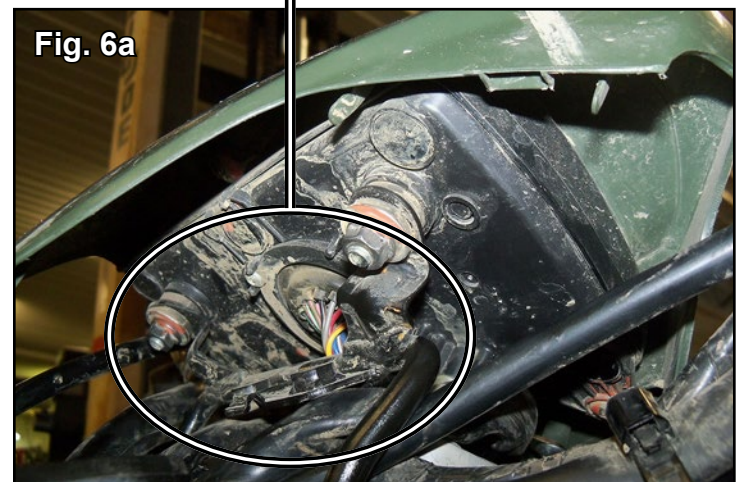
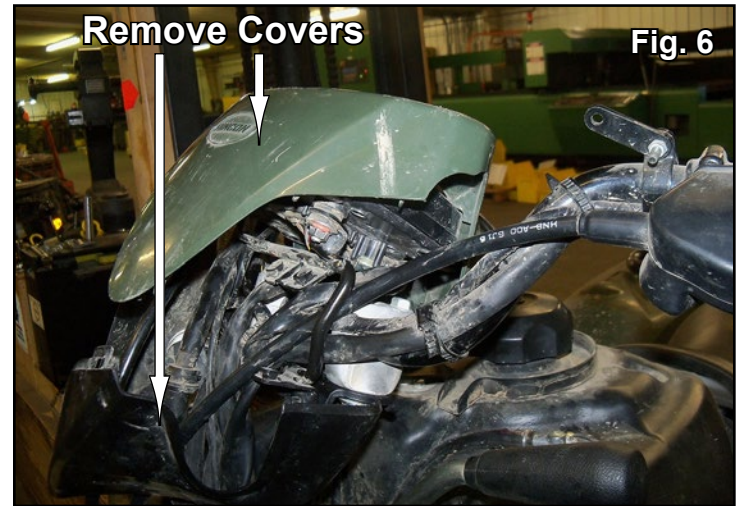



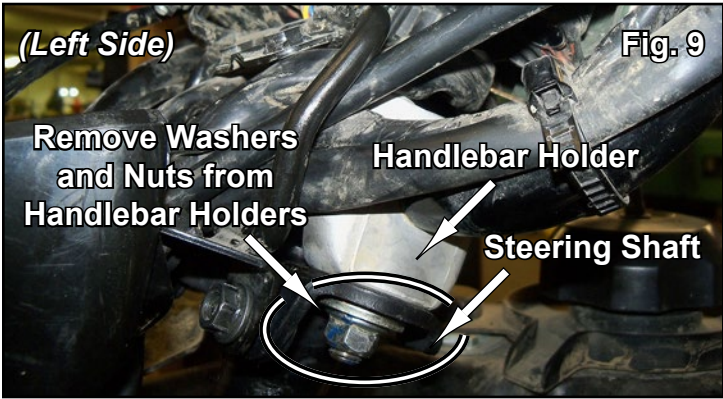
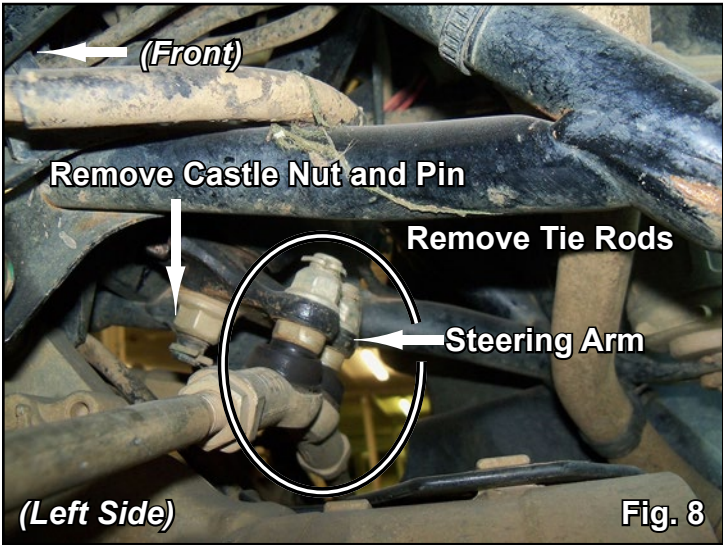



**Installation:** Do not tighten hardware completely unless noted.

1. Assemble Control Module (J) to Control Module Mounting Bracket (P) with M6-1.0 x 16mm Lg. HHCS (C). See Fig. 1.
2. Install Lower Shaft (H) to stock location. Secure with stock hardware. See Figs. 2 - 2a.
3. Loosely reinstall Tie Rods to Lower Shaft (H) with stock hardware. See Fig. 2a.
4. Install Motor (K) onto Lower Shaft (H). Secure with provided hardware. See Motor Shafts Detail and Fig. 3.
5. Secure Mounting Bracket (N) to Motor (K) with M8-1.25 x 20mm Lg. Hex Flange Bolts (A). See Fig. 4.
  - Locate (2) holes in Shift Gate Plate and install Mounting Bracket Support (U) with M6-1.0 x 25mm Lg. HHCS (D) and M6 Nylock Nuts, Flange (F). See Fig. 4.
  - Install opposite end of Mounting Bracket Support (U) to Mounting Bracket (N) with M8-1.25 x 25mm Lg. FHCS (V) and M8-1.25 Nylock Nuts, Flange (T). See Fig. 4.
  - Install Support Bracket (B) to Steering Frame with M8-1.25 x 25mm Lg. HHCS (V) and M8-1.25 Nylock Nut, Flange (T). See Fig. 4.
  - Install opposite end of Support Bracket (B) to Mounting Bracket (N) with M6-1.0 x 25mm Lg. HHCS (D) and M6 Nylock Nut, Flange (F). See Fig. 4.
6. Apply grease and install stock Steering Bushing to Upper Shaft (G). From top of machine, install Upper Shaft (G) to Motor (K). Secure to Motor (K) with provided hardware. See Fig. 5.
  - Secure Upper Shaft (G) to Frame with M8 Flat Washers (E) and stock hardware.
7. Install Control Module Mounting Bracket Assembly (J)(P) to machine with M10-1.50 x 30mm Lg. HHCS (Q), M10 Flat Washers (R), and M10-1.50 Nylock Nut (S). See Figs. 6 - 6a.
  - Plug in Wire Harness (L) but do not wire.
8. Reinstall Handlebar to Upper Shaft (G) with stock hardware. See Fig. 9 from "Removal", page 8.

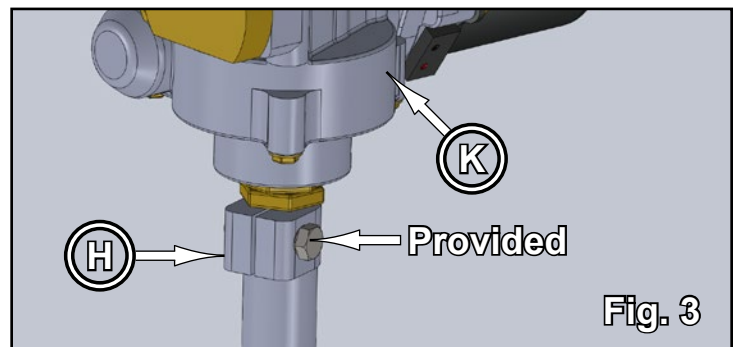
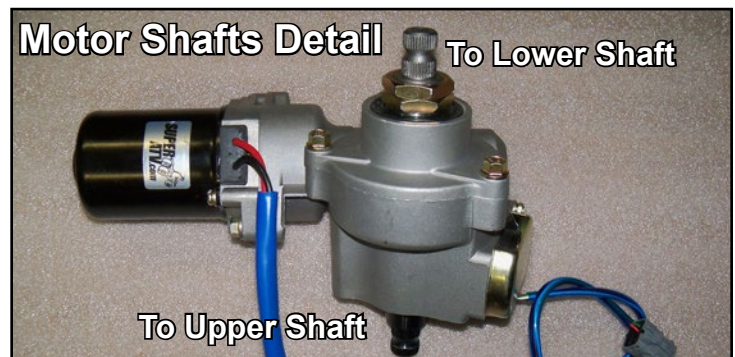
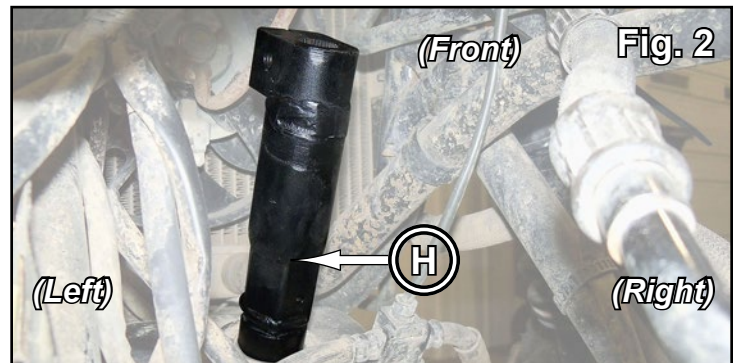
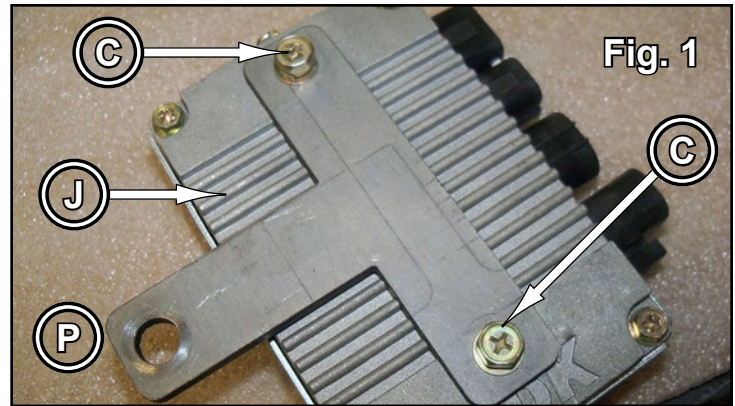

**Handlebar should be inline with Tie Rods before tightening hardware. Lift Handlebar up and off of Motor (K) and realign if not.**

9. Make wire connections. See Wiring Details pages 12 - 13.
10. Tighten all hardware completely.
11. Reverse steps taken during "Removal" and reinstall components.

**Fig. 4, Mounting Brackets**

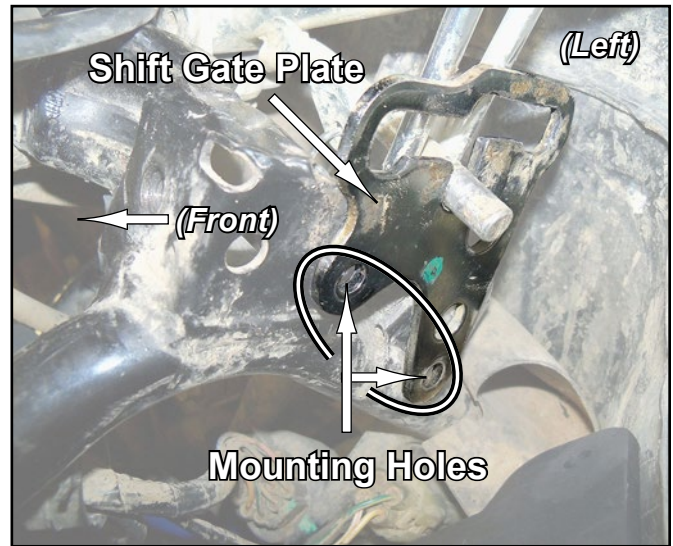
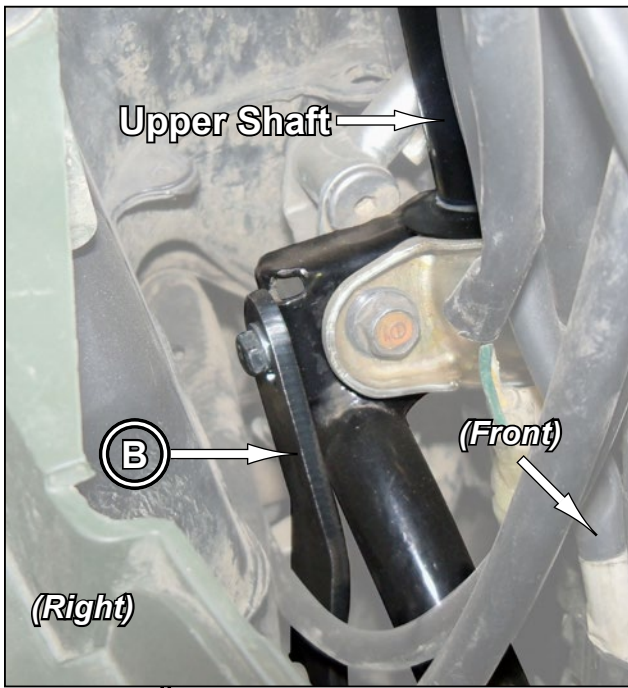

**PARTS REFERENCE**

| Item | Description                     |
|------|---------------------------------|
| A    | M8-1.25 x 20mm Lg. FHCS         |
| B    | Support Bracket                 |
| C    | M6-1.0 x 16mm Lg. HHCS          |
| D    | M6-1.0 x 20mm Lg. FHCS          |
| E    | M8 Flat Washers                 |
| F    | M6-1.0 Nylock Nuts, Flange      |
| G    | Upper Shaft                     |
| H    | Lower Shaft                     |
| J    | Control Module                  |
| K    | Motor                           |
| L    | Wiring Harness                  |
| M    | Wiring Connectors Kit           |
| N    | Mounting Bracket                |
| P    | Control Module Mounting Bracket |
| Q    | M10-1.50 x 30mm Lg. HHCS        |
| R    | M10 Flat Washers                |
| S    | M10-1.50 Nylock Nut             |
| T    | M8-1.25 Nylock Nuts, Flange     |
| U    | Mounting Bracket Support        |
| V    | M8-1.25 x 25mm Lg. FHCS         |

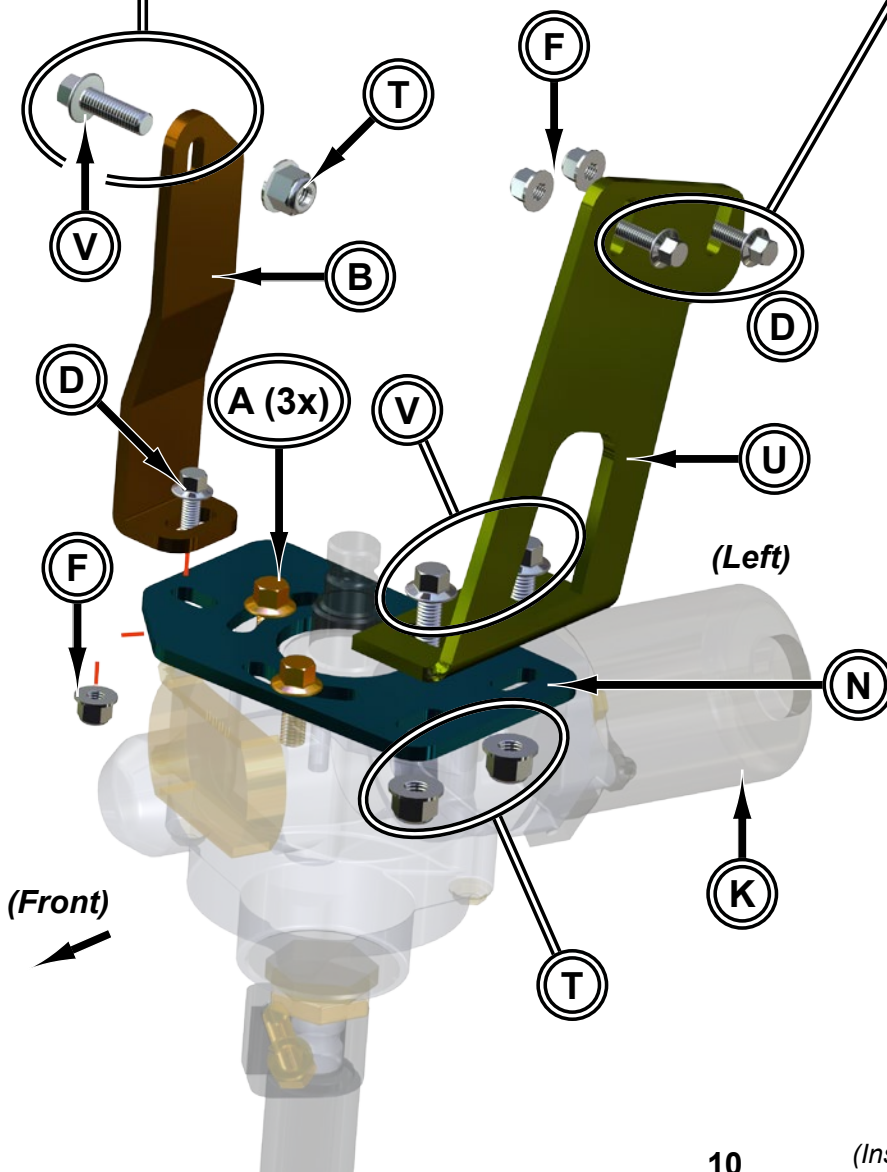



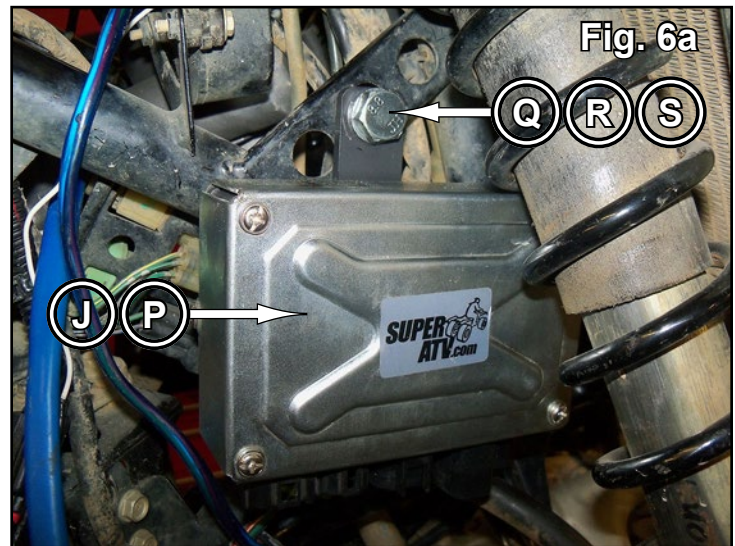
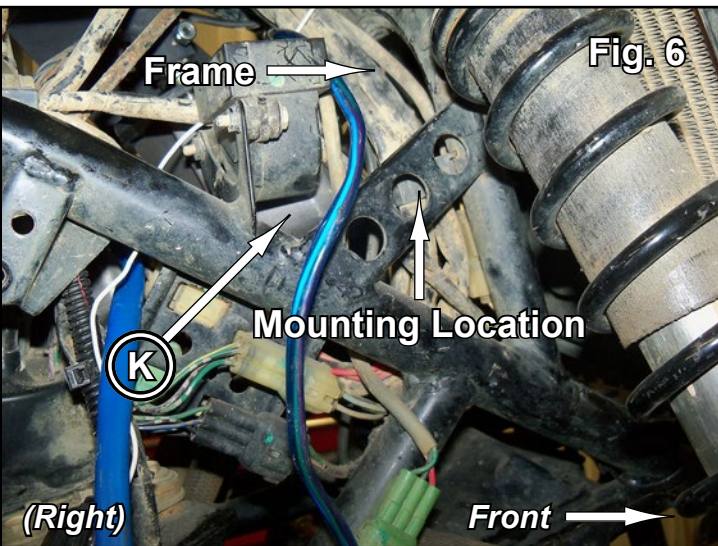
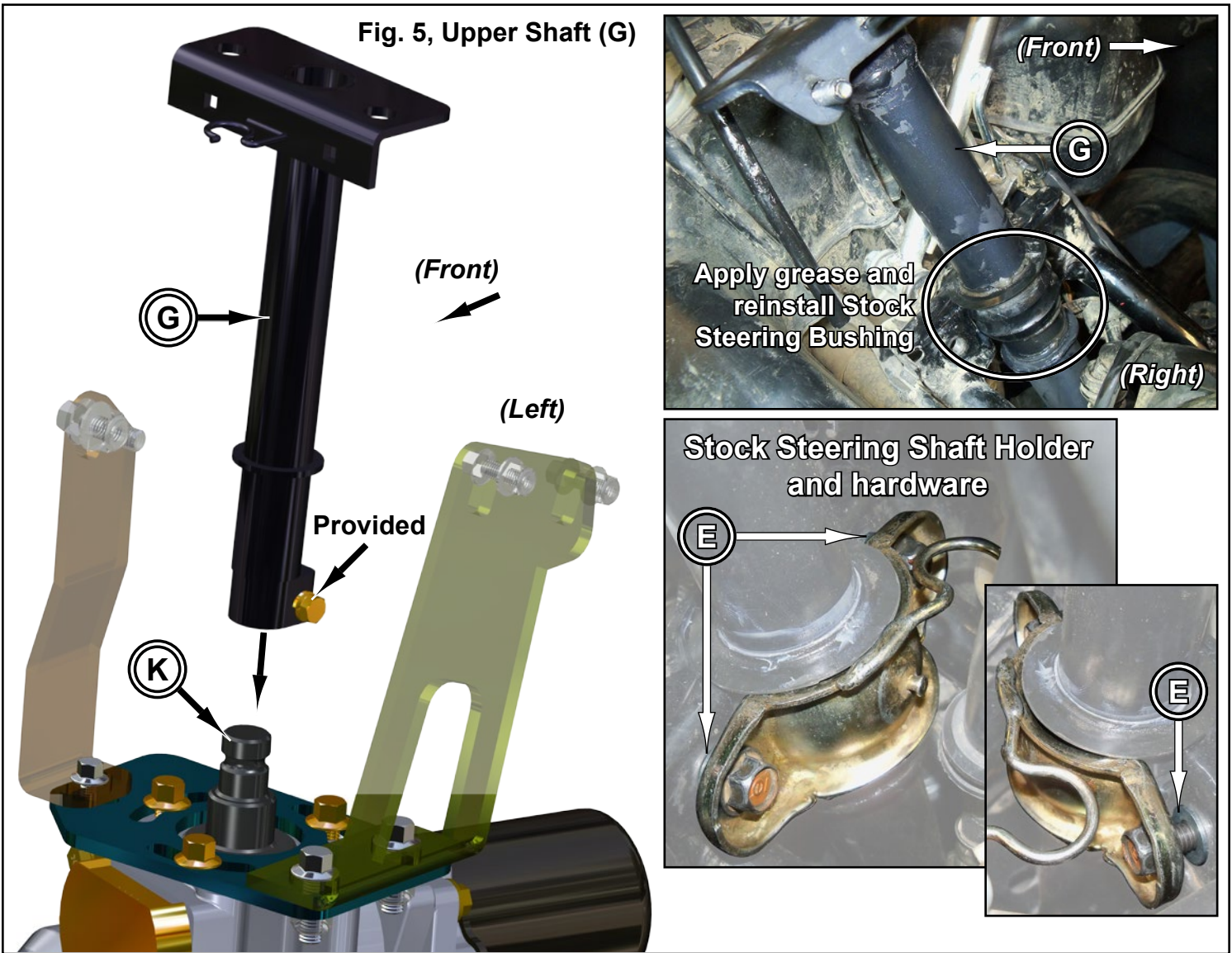



## Wiring Details

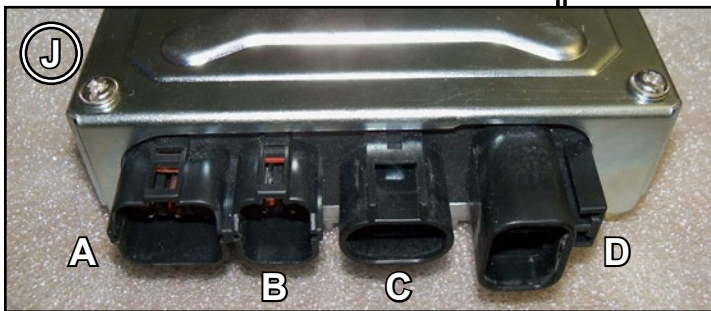
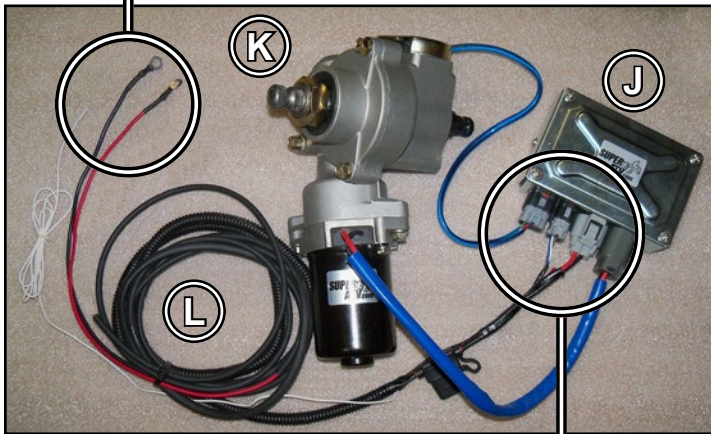
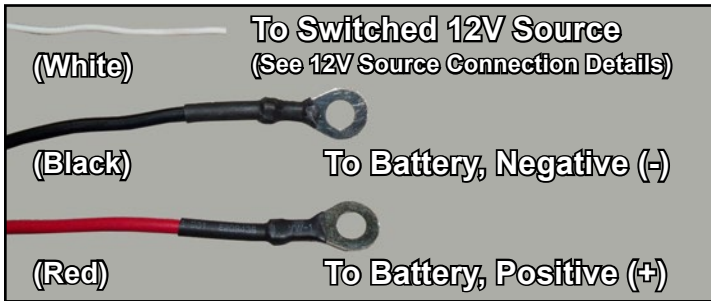

| Plug | Function            |
|------|---------------------|
| A    | Torque Sensor       |
| B    | Switched 12V Source |
| C    | Power               |
| D    | Motor               |

When activated, Diagnostic Light will flash (1) time for about (1) second before turning off indicating proper function. Should different patterns occur, contact SuperATV.

Secure Diagnostic Light in a visible location.

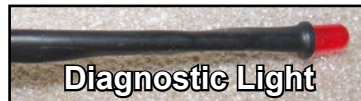

### Switched 12V Source Connection Details

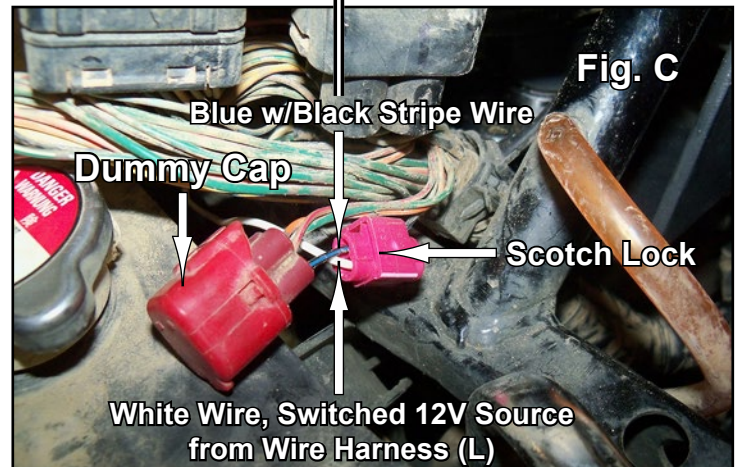
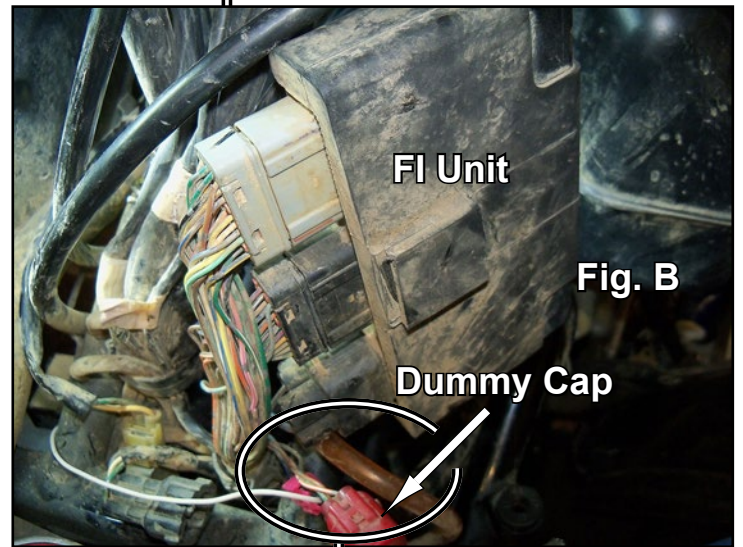
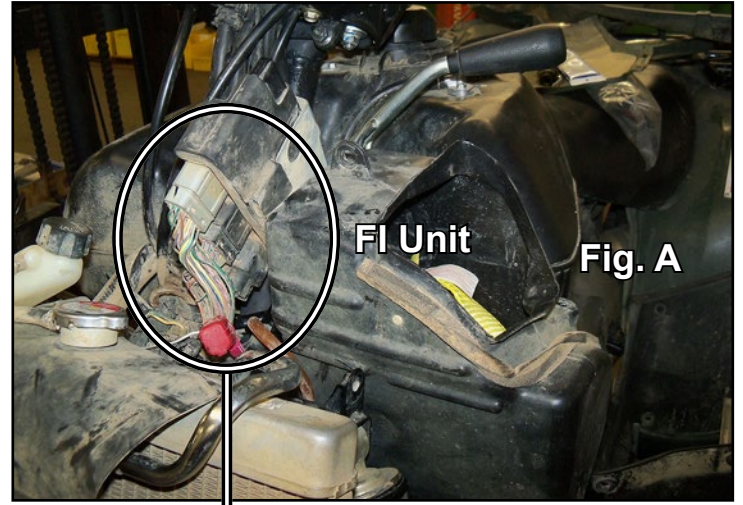

Soldering connection is recommended however, installer may use other forms of connecting.

1. Locate FI Unit and connection with Dummy Cap. See Figs. A - B.
2. Connect White Wire from Wire Harness (L) to Blue with Black Stripe wire. Scotch Lock (included), Spade Connector (not included), or solder. See Fig. C.



## Wiring Details, continued



### Battery Connections

