

INSTALLATION INSTRUCTIONS

Can-Am Renegade Power Steering

Item	Description	Qty
A	Lower Steering Shaft	1
B	Mounting Bracket	1
C	Upper Steering Shaft	1
D	Wiring Harness	1
E	Motor	1
F	Control Module	1
G	Control Module Mounting Bracket	1
H	Wiring Connectors Kit	1
J	M8-1.25 x 20mm Lg. Hex Flange Bolts	3
K	O-Rings	2
L	M6-1.0 x 16mm Lg. HHCS	2
M	M6-1.0 x 55mm Lg. HHCS	1
N	Heat Shield	1
P	Stiffener	1
R	M6-1.0 x 16mm Lg. HHCS	1
S	M6-1.0 Nylock Nuts	4
T	M6 Flat Washers	8
U	M6-1.0 x 30mm Lg. HHCS	2

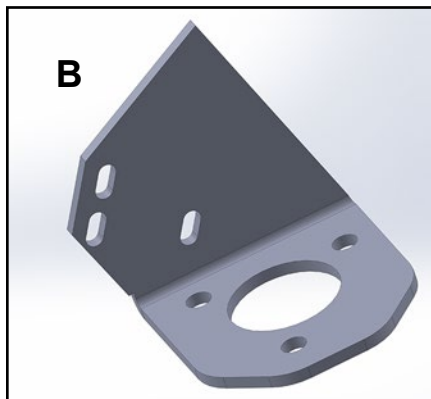
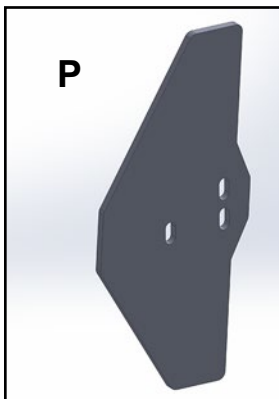
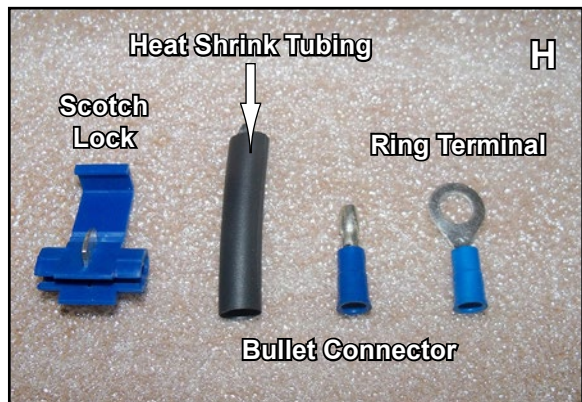
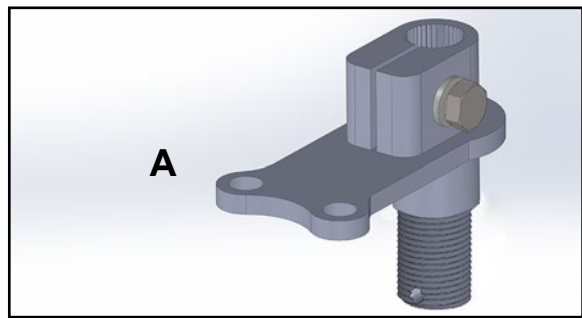

Read instructions and view illustrations before beginning.

Need help with your installation?

 sales@superatv.com
 www.superatv.com

 1-812-574-7777
  8:00am - 9:00pm EST M-Th
 8:00am - 7:00pm EST Friday
 9:00am - 2:00pm EST Saturday

Thank You
For Choosing

Liability Statement
 SuperATV's products are designed to best fit users ATV/UTV under stock conditions. Adding, modifying, or fabricating any factory, or aftermarket, parts will void any warranty provided by SuperATV and is not recommended. SuperATV's products could interfere with other aftermarket accessories. If user has aftermarket products on machine, contact SuperATV to verify that they will work together.

Although SuperATV has thousands of satisfied customers, user should be aware that installing lift kits, long travel, or suspension kits, tires, etc will change the ride of machine and may increase maintenance and part wear. Operating any off-road machine while, or after, consuming alcohol and/or drugs increases risk of bodily harm or death. No warranty or representation is made as to this product's ability to protect user from severe injury or death. SuperATV urges operators and occupants to wear a helmet and appropriate riding gear at all times.

By purchasing and installing SuperATV products, user agrees that should damages occur, SuperATV will not be held responsible for loss of time, use, labor fees, replacement parts, or freight charges. SuperATV, nor any 3rd party, will not be held responsible for any direct, indirect, incidental, special, or consequential damages that result from any product purchased from SuperATV. The total liability of seller to user for all damages, losses, and causes of action, if any, shall not exceed the total purchase price paid for the product that gave rise to the claim.

SuperATV will warranty only parts provided by SuperATV. Any damage or problems with OEM housings, bearings, seals, or other manufacturers products will not be covered by SuperATV. SuperATV parts and products are not warranted if item was not installed properly, misused, or modified.

Item	Description	Qty
A	Lower Steering Shaft	1
B	Mounting Bracket	1
C	Upper Steering Shaft	1
D	Wiring Harness	1
E	Motor	1
F	Control Module	1
G	Control Module Mounting Bracket	1
H	Wiring Connectors Kit	1
J	M8-1.25 x 20mm Lg. Hex Flange Bolts	3
K	O-Rings	2
L	M6-1.0 x 16mm Lg. HHCS	2
M	M6-1.0 x 55mm Lg. HHCS	1
N	Heat Shield	1
P	Stiffener	1
R	M6-1.0 x 16mm Lg. HHCS	1
S	M6-1.0 Nylock Nuts	4
T	M6 Flat Washers	8
U	M6-1.0 x 30mm Lg. HHCS	2

(Kit contents continued)

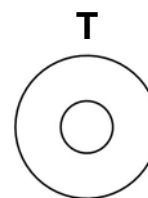
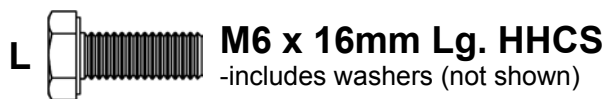
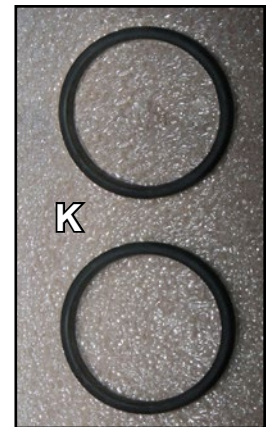
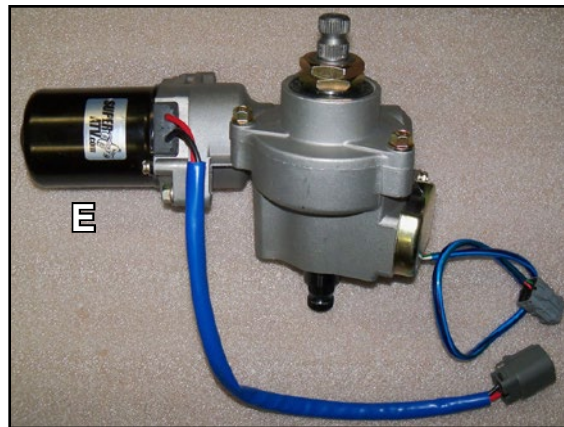
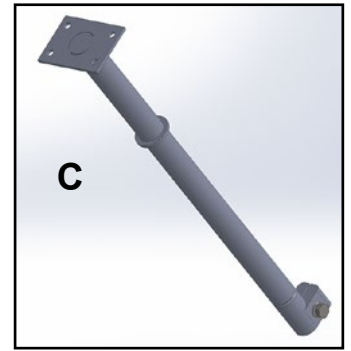
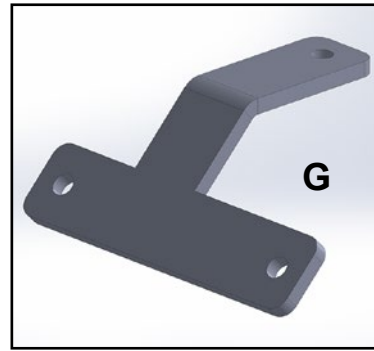

M6 Flat Washer



M6 Nylock Nut

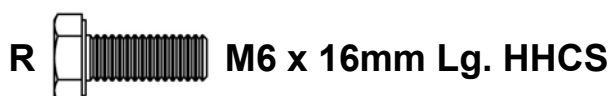



For reference, photographing of removal process is highly recommended due to amount of components being removed from machine.

Removal: *Keep all stock hardware removed from machine.*

1. Raise front of machine, secure with jack stands, and remove Wheels.
2. Remove Inner Fenders and Intake. See Figs. 1 - 1a.
3. Remove Tie Rods from Steering Stem. See Fig. 3.
4. Remove Castle Nut and Cotter Pin from Steering Stem. See Fig. 3.
5. Remove hardware from Steering Stem as shown in Fig. 4.
6. If necessary, unplug wiring harness' and move wiring aside as shown in Fig. 5. Remove Control Module. See Fig. 5a.
7. Remove Module Support. See Fig. 6.
 - (2) Bolts securing Module Support also secure Steering Stem to Frame. See Fig. 7.
8. From top of ATV, remove Steering Stem. Discard stock O-Rings. See Figs. 8 - 8a.
9. Remove hardware securing Ignition Coil to machine; hang out of way. See Fig. 9

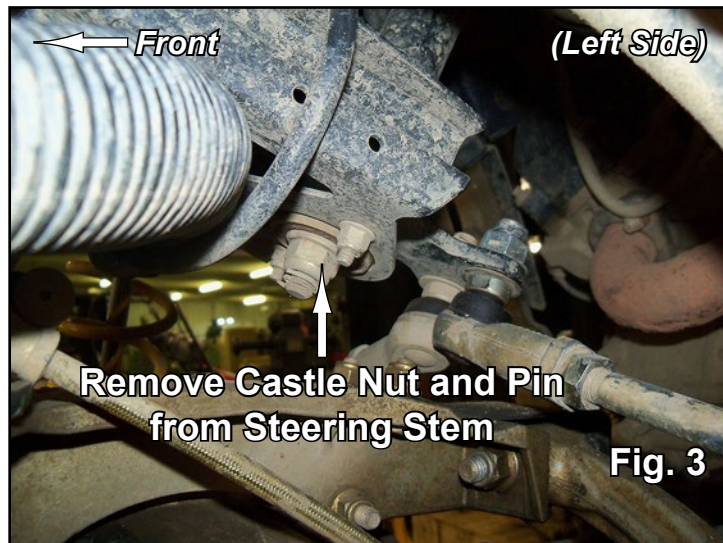
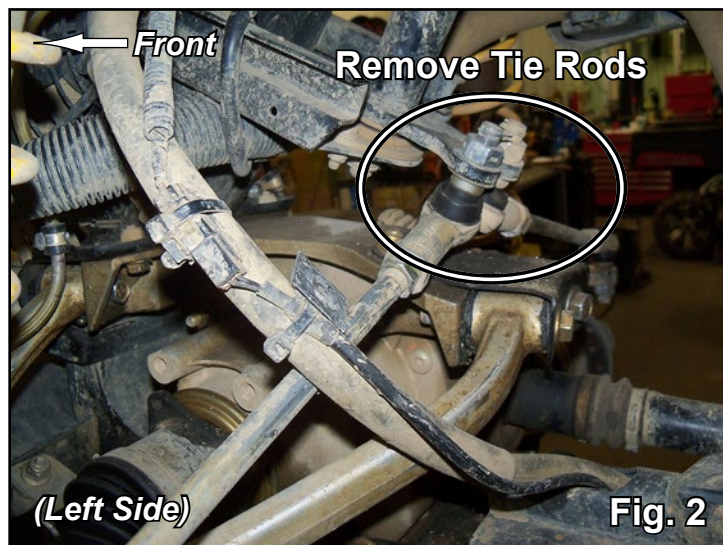

(removal illustrations continue on following pages)

(removal illustrations continued)

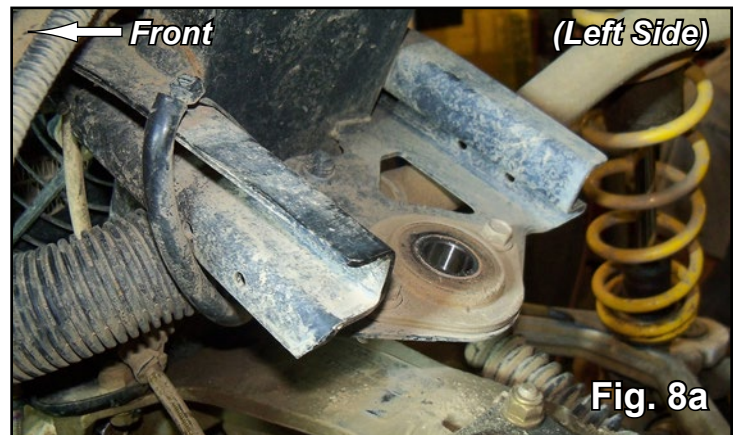
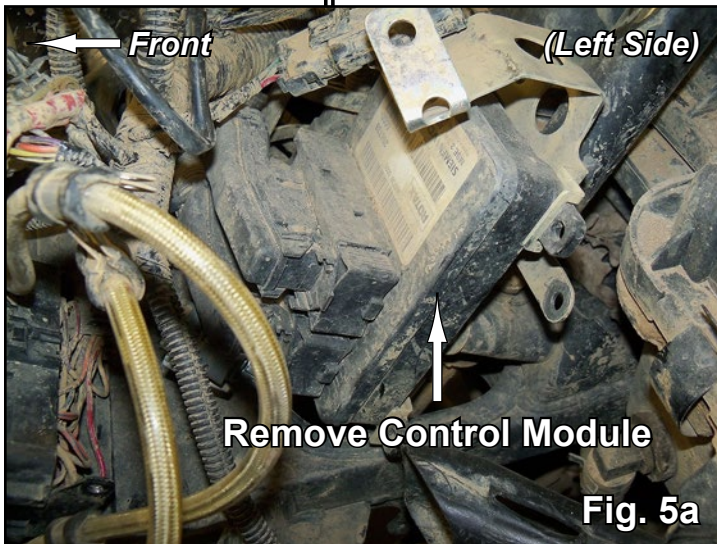
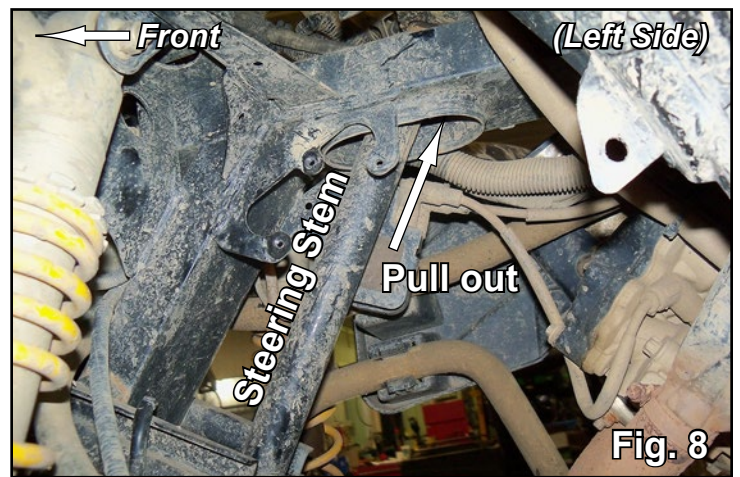
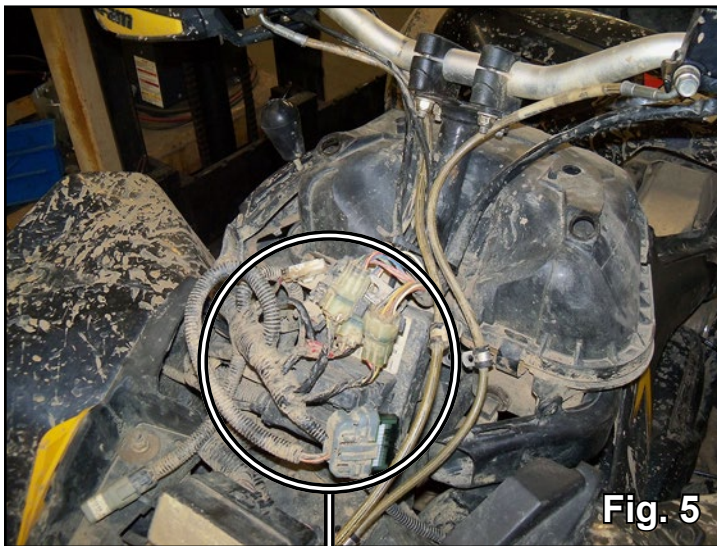
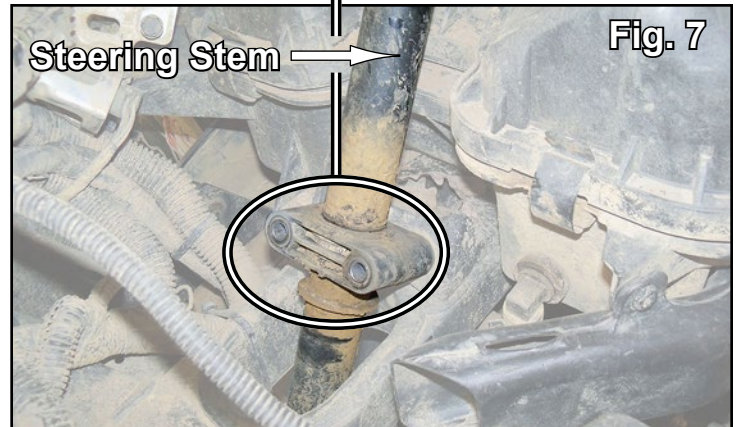
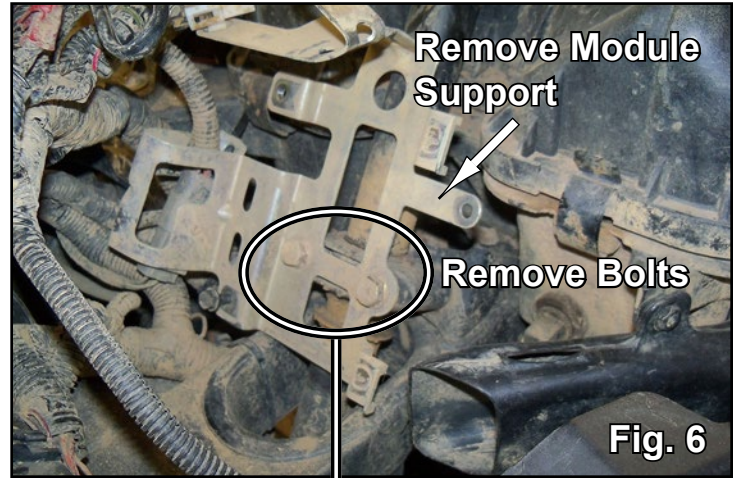

(removal illustrations continue on following page)

(removal illustrations continued)

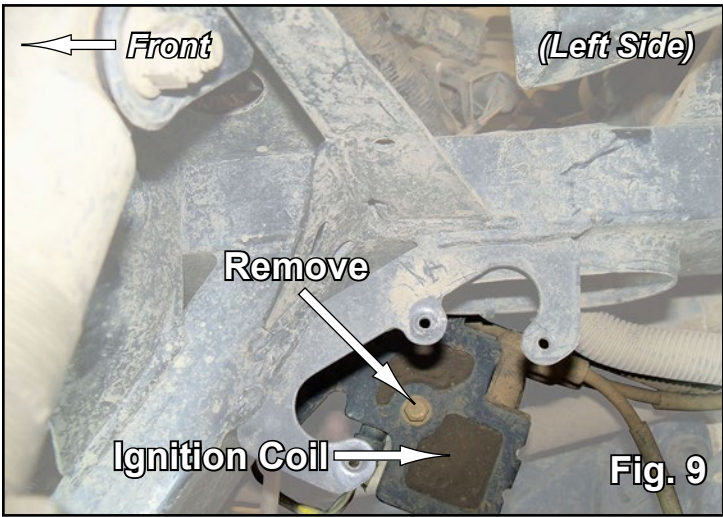

CONNECTIONS

- Before installing, ensure that all waterproof connections are properly seated.
- If Gaskets are not seated, as shown, use a Flathead Screwdriver to seat.

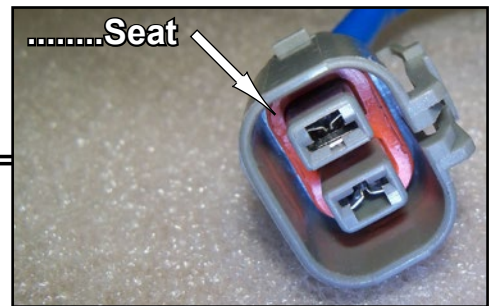
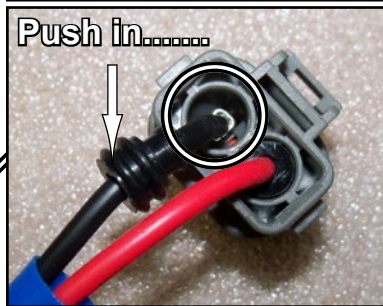
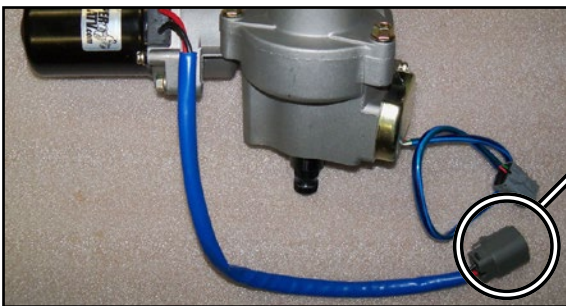
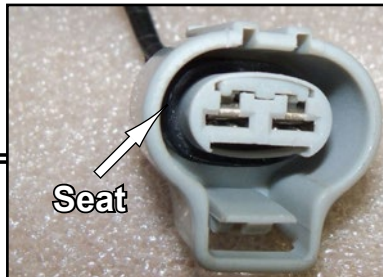
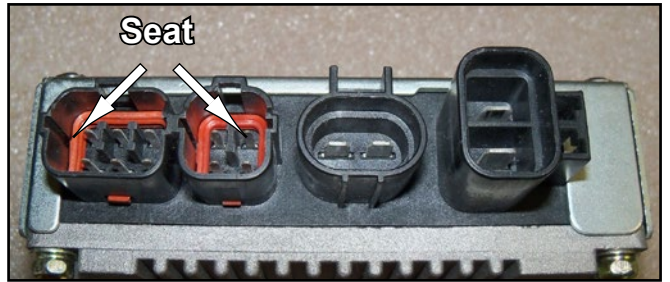

Installation:

Do not tighten hardware completely unless noted.

1. Install Mounting Bracket (B) to Motor (E) with M8-1.25 x 20mm Lg. Hex Flange Bolts (J). See Fig. 1.
2. Install Lower Steering Shaft (A) to machine. Secure with stock Castle Nut and Cotter Pin. See Figs. 2 - 2a. Reconnect Tie Rods with stock hardware.
3. Install Motor (E) to Lower Steering Shaft (A) with supplied hardware. See Fig. 3 and Motor Shafts Detail.
4. Secure Mounting Bracket (B) and Stiffener (P) to machine with M6-1.0 x 30mm Lg. HHCS (U), M6 Flat Washers (T), and M6-1.0 Nylock Nuts (S). See Bracket Mounting, Figs. 4 - 4b.
 - Reinstall Ignition Coil to Stiffener (P) with M6-1.0 x 55mm Lg. HHCS (M), M6 Flat Washer (T), and M6-1.0 Nylock Nut (S).
5. Install O-Rings (K) onto Upper Steering Shaft (C). See Figs. 5 - 5a.
6. Install Upper Shaft (C) to Motor (E) with supplied hardware. See Figs. 6 - 6b.
 - Install from top of machine and secure Module Support, Column Attachment, and Upper Steering Shaft (C) to Frame with stock hardware.
7. Assemble Control Module Mounting Bracket (G) to Control Module (F) with M6-1.0 x 16mm Lg. HHCS (L). Plug in, but do not wire, Wiring Harness (D). See Control Module Mounting, Fig. 7.
8. Locate hole in Module Support bracket and install Control Module assembly with M6-1.0 x 16mm Lg. HHCS (R), M6 Flat Washer (T), and M6-1.0 Nylock Nut (S).
9. Remove Nuts from Exhaust Flange, install Heat Shield (N), and replace Nuts. See Fig. 8.
10. Go to pages 11 - 12 for Wiring Details.

Handlebar should be inline with Tie Rods before tightening hardware. Lift Handlebar up and off of Motor (E) and realign if not.

11. Tighten all hardware completely and reverse applicable steps taken during "Removal".

Power Steering will provide multiple improvements to your machine. After installation, it is highly recommend to take time and learn your machines new handling characteristics and feel.

Key Recommendations:

1. Power Steering Benefits will be noticed as soon as machine is moving.
2. Handlebar will have more noticeable deflection while at rest. As a result of speed sensitive operation, this is normal.
3. Check steering sensitivity at multiple speeds to best understand new handling characteristics and feel.
4. Without Throttle input, turning Handlebar back and forth unnecessarily is not recommended. This action is very hard on remaining stock steering components, Tie Rod Ends, and Power Steering unit.

Like all SuperATV products, Power Steering kits were designed with riders in mind.

(installation illustrations continued)

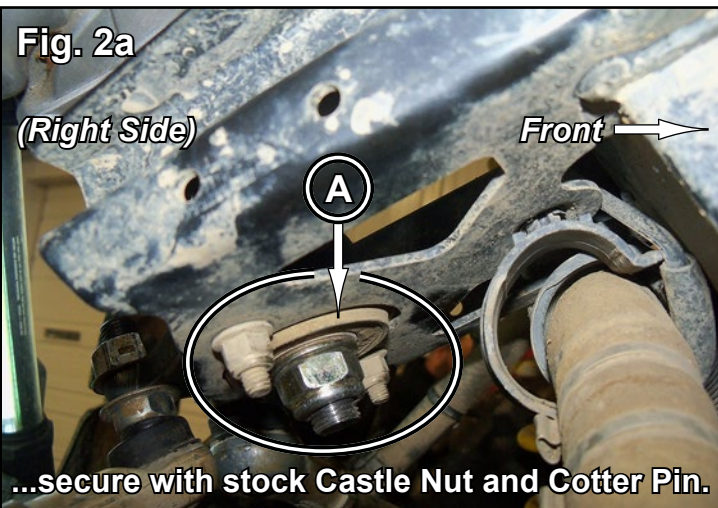
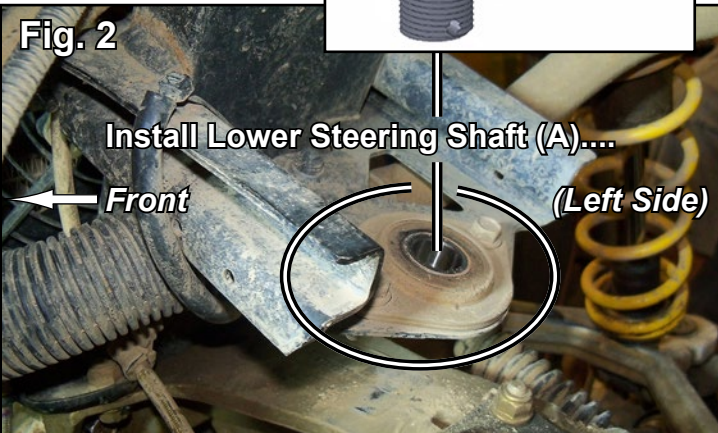
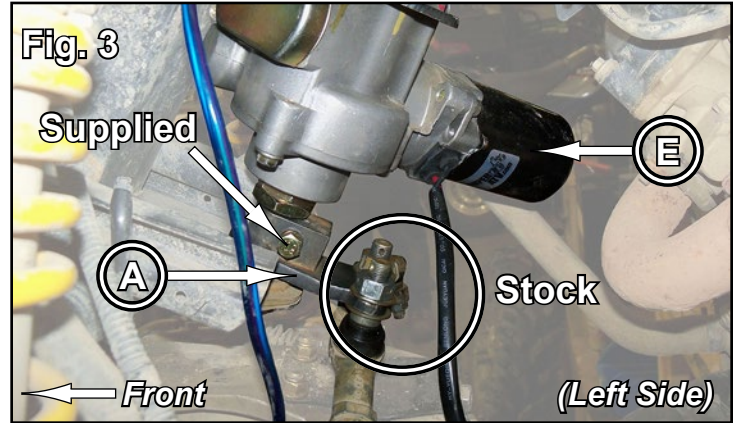
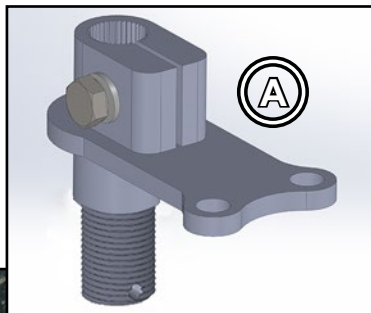
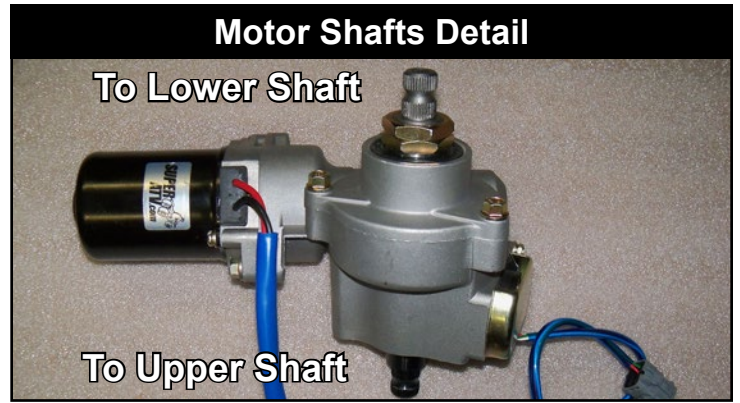
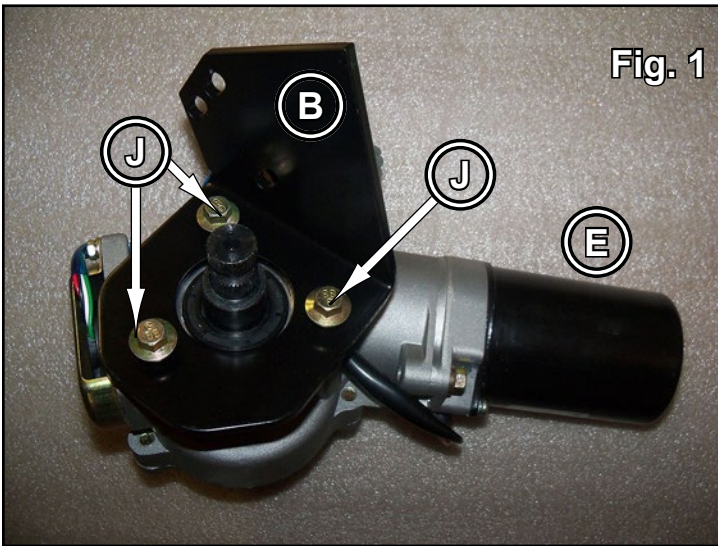

PARTS REFERENCE

Item	Description
A	Lower Steering Shaft
B	Mounting Bracket
C	Upper Steering Shaft
D	Wiring Harness
E	Motor
F	Control Module
G	Control Module Mounting Bracket
H	Wiring Connectors Kit
J	M8-1.25 x 20mm Lg. Hex Flange Bolts
K	O-Rings
L	M6-1.0 x 16mm Lg. HHCS
M	M6-1.0 x 55mm Lg. HHCS
N	Heat Shield
P	Stiffener
R	M6-1.0 x 16mm Lg. HHCS
S	M6-1.0 Nylock Nuts
T	M6 Flat Washers
U	M6-1.0 x 30mm Lg. HHCS

(installation illustrations continue on following pages)

(installation illustrations continued)

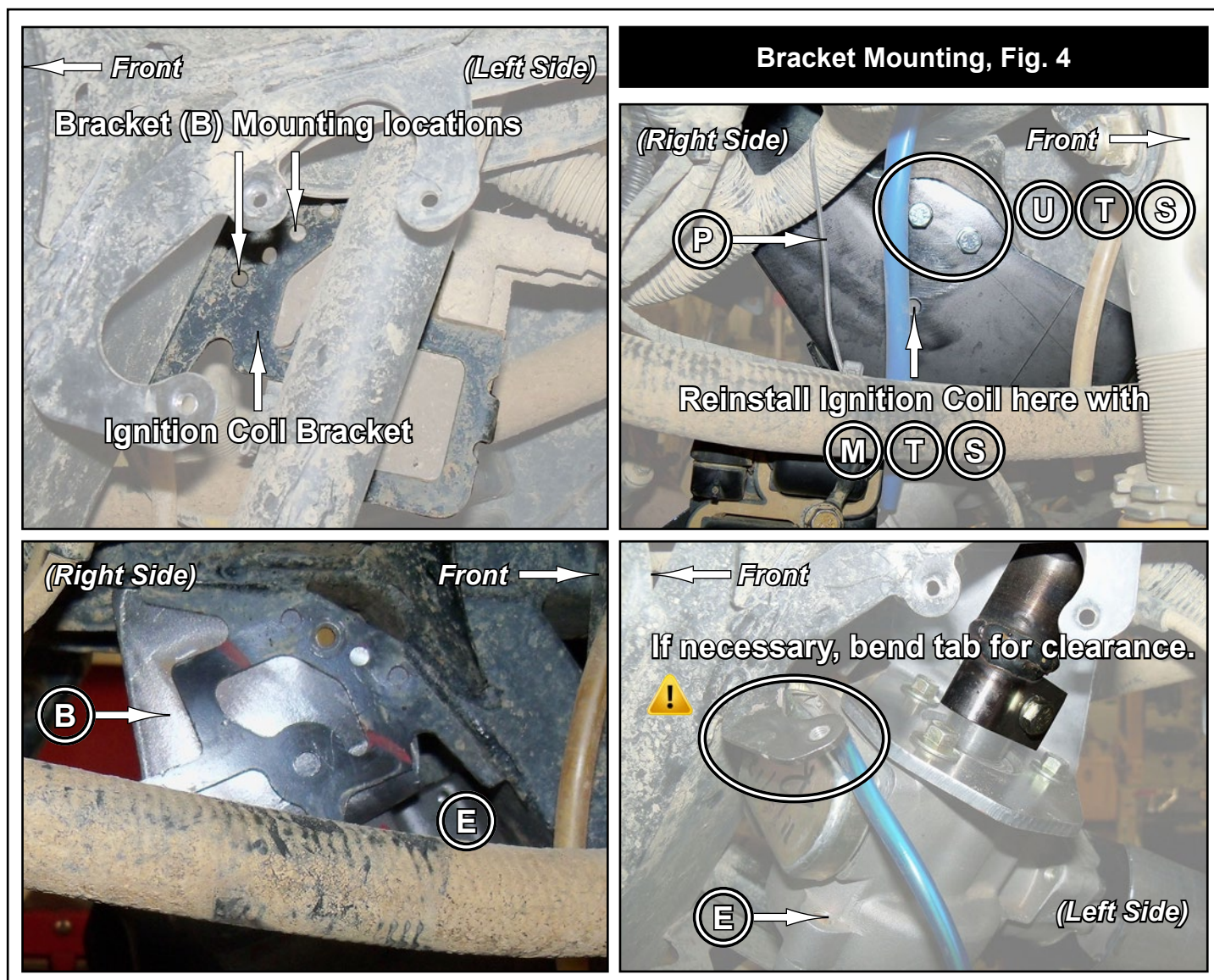

PARTS REFERENCE

Item	Description	Item	Description
A	Lower Steering Shaft	K	O-Rings
B	Mounting Bracket	L	M6-1.0 x 16mm Lg. HHCS
C	Upper Steering Shaft	M	M6-1.0 x 55mm Lg. HHCS
D	Wiring Harness	N	Heat Shield
E	Motor	P	Stiffener
F	Control Module	R	M6-1.0 x 16mm Lg. HHCS
G	Control Module Mounting Bracket	S	M6-1.0 Nylock Nuts
H	Wiring Connectors Kit	T	M6 Flat Washers
J	M8-1.25 x 20mm Lg. Hex Flange Bolts	U	M6-1.0 x 30mm Lg. HHCS

(installation illustrations continue on following pages)

(installation illustrations continued)

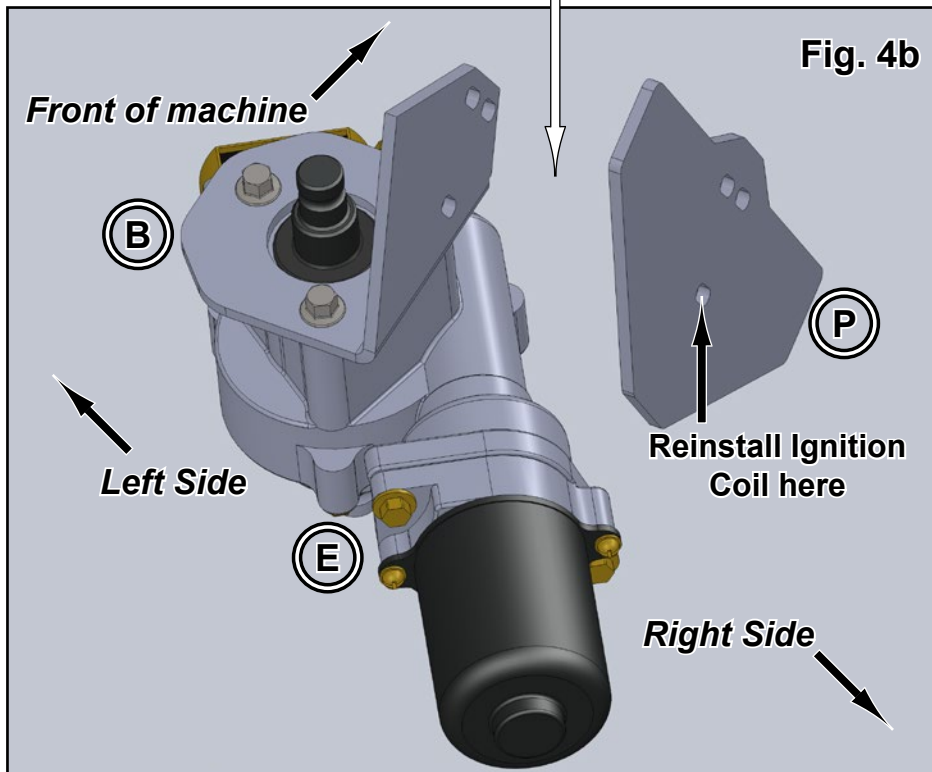
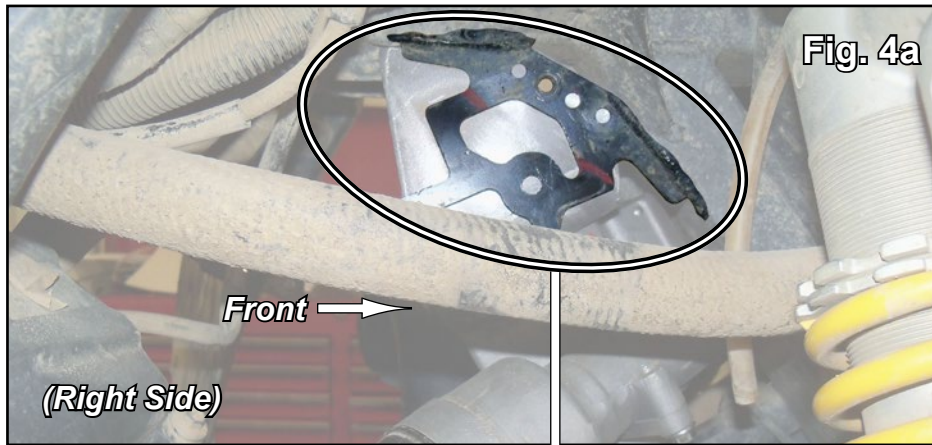

(installation illustrations continue on following pages)

Install Set Screws (Q) prior to installing.

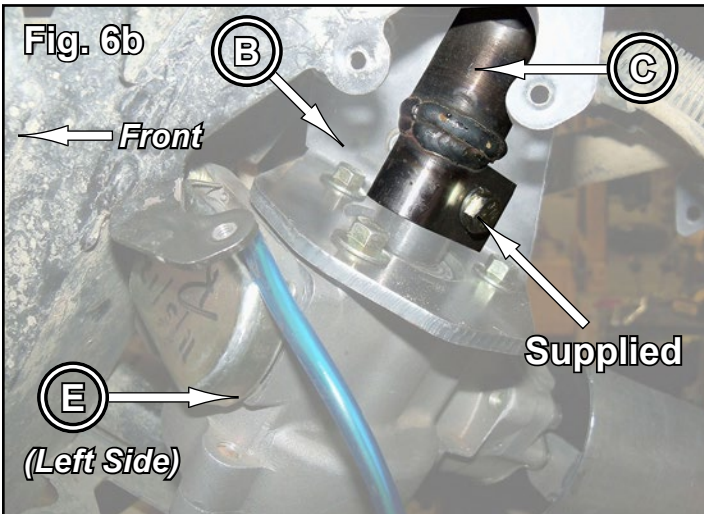
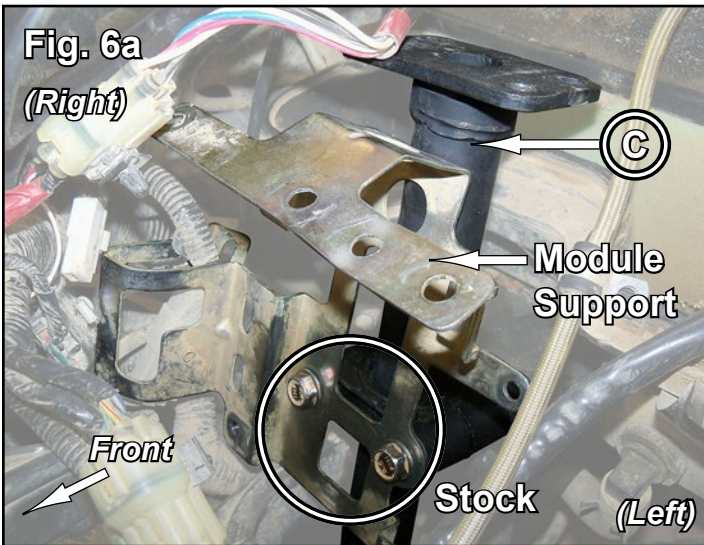
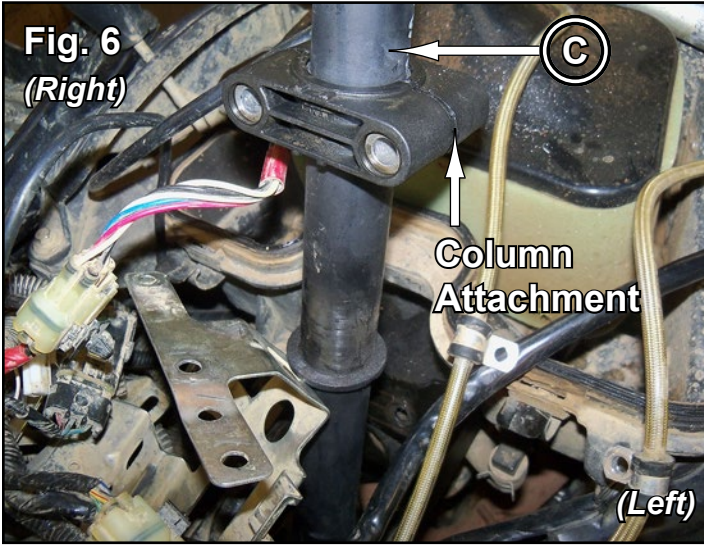

Control Module Mounting, Fig. 7

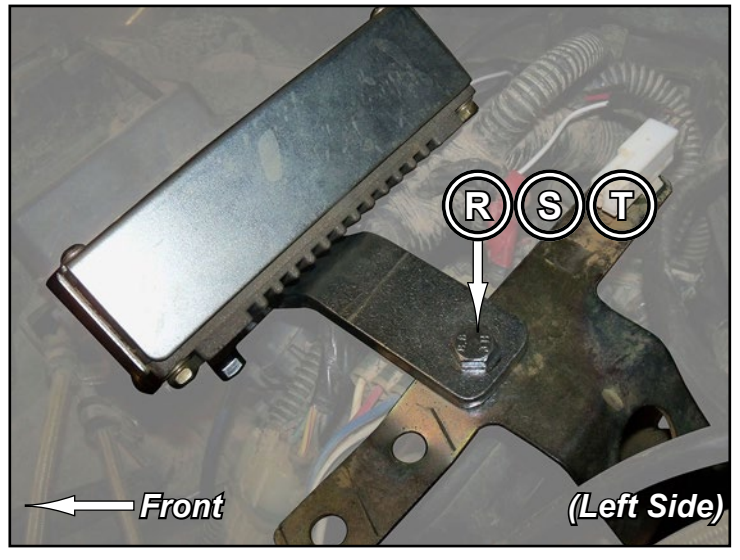
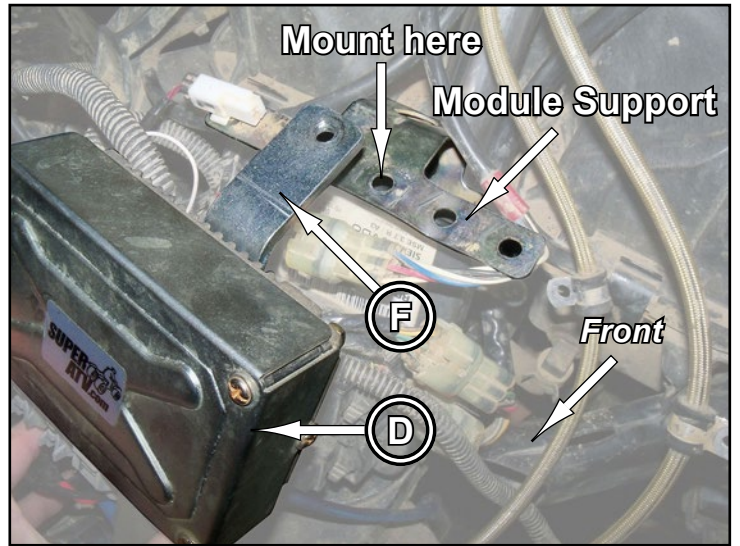
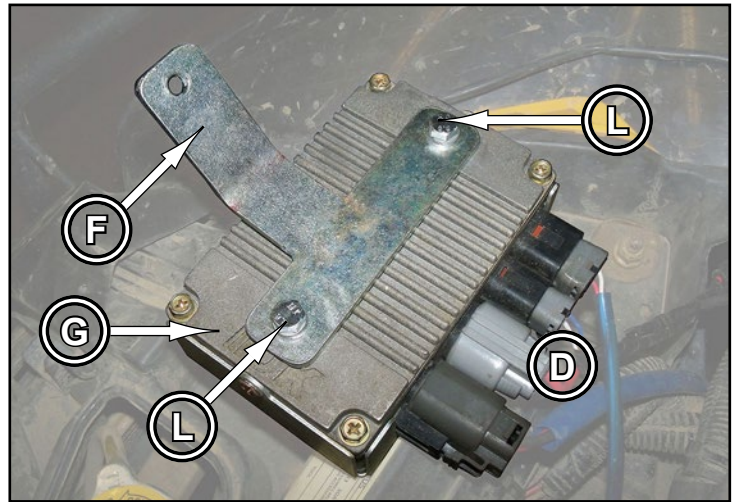

(Installation illustrations continue on following pages)

Heat Shield (N), Fig. 8

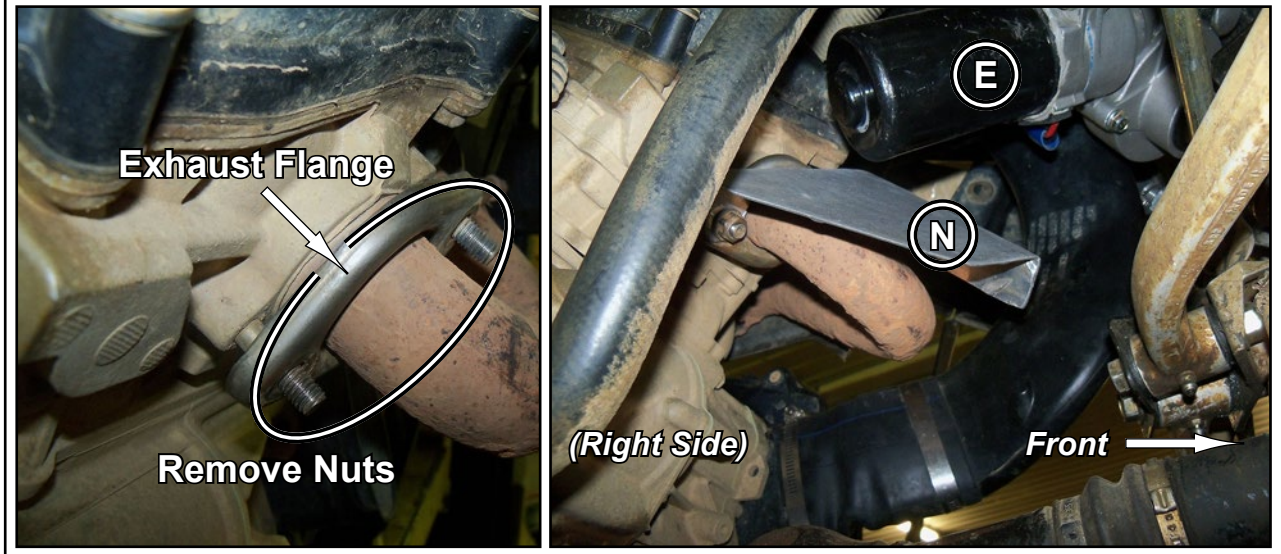

WIRING DETAILS

(White) To Switched 12V Source
(See 12V Source Connection)

(Black) To Battery, Negative (-)

(Red) To Battery, Positive (+)

When activated, Diagnostic Light will flash (1) time for about (1) second before turning off indicating proper function. Should different patterns occur, contact SuperATV.

Secure Diagnostic Light in a visible location.

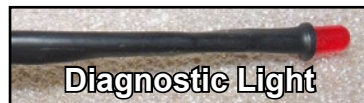

Plug	Function
A	Torque Sensor
B	Switched 12V Source
C	Power
D	Motor

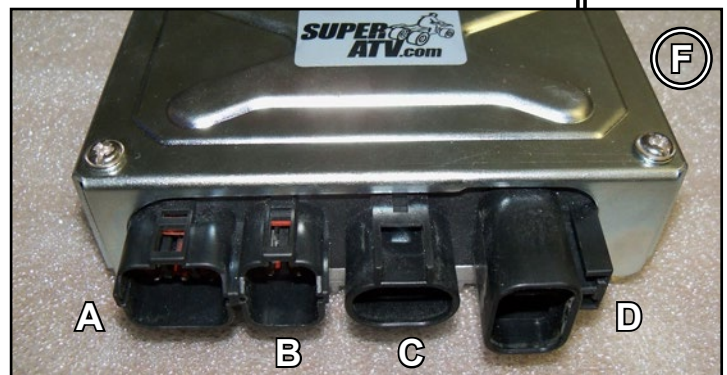
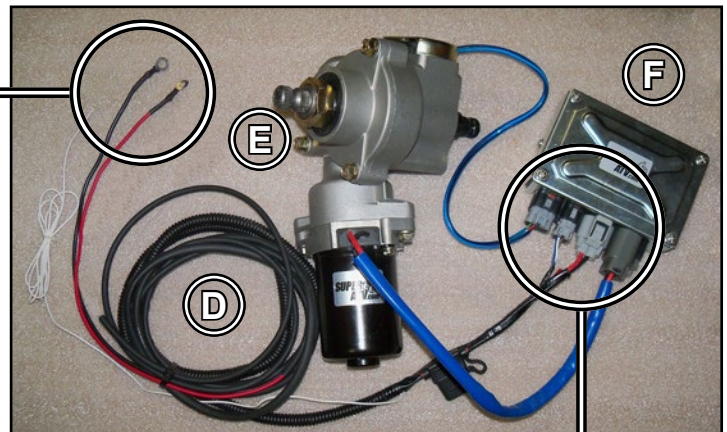

(wiring illustrations continue on following page)

(wiring illustrations continued)

12V Source Connection

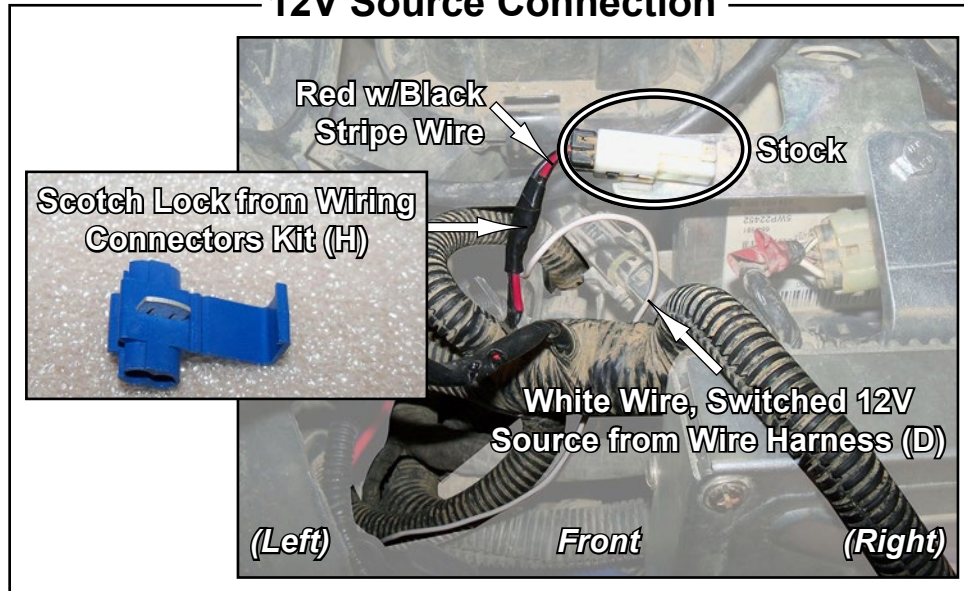

Power Connections

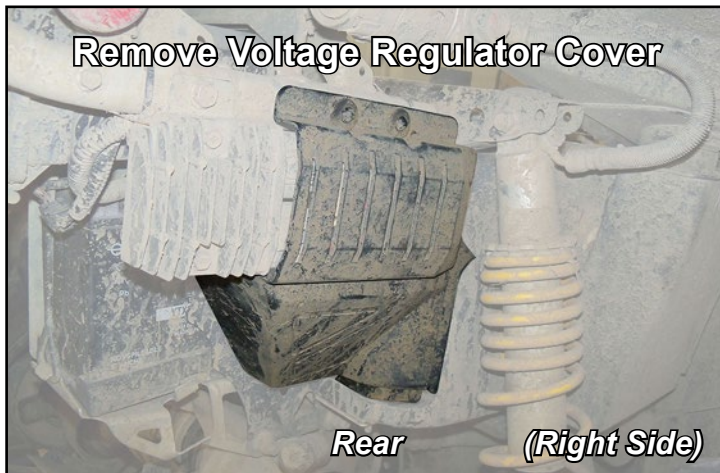

1. Remove Voltage Regulator Cover.
2. Locate Starter Relay and Ground Lug.
3. Red Wire (positive) connects to Starter Relay post and Black Wire (ground) connects to Ground Lug.

