

**Please attach UPS Return Label here:**

A large, empty rectangular box with rounded corners, intended for attaching a UPS Return Label. The box is outlined in black and occupies the central portion of the page.

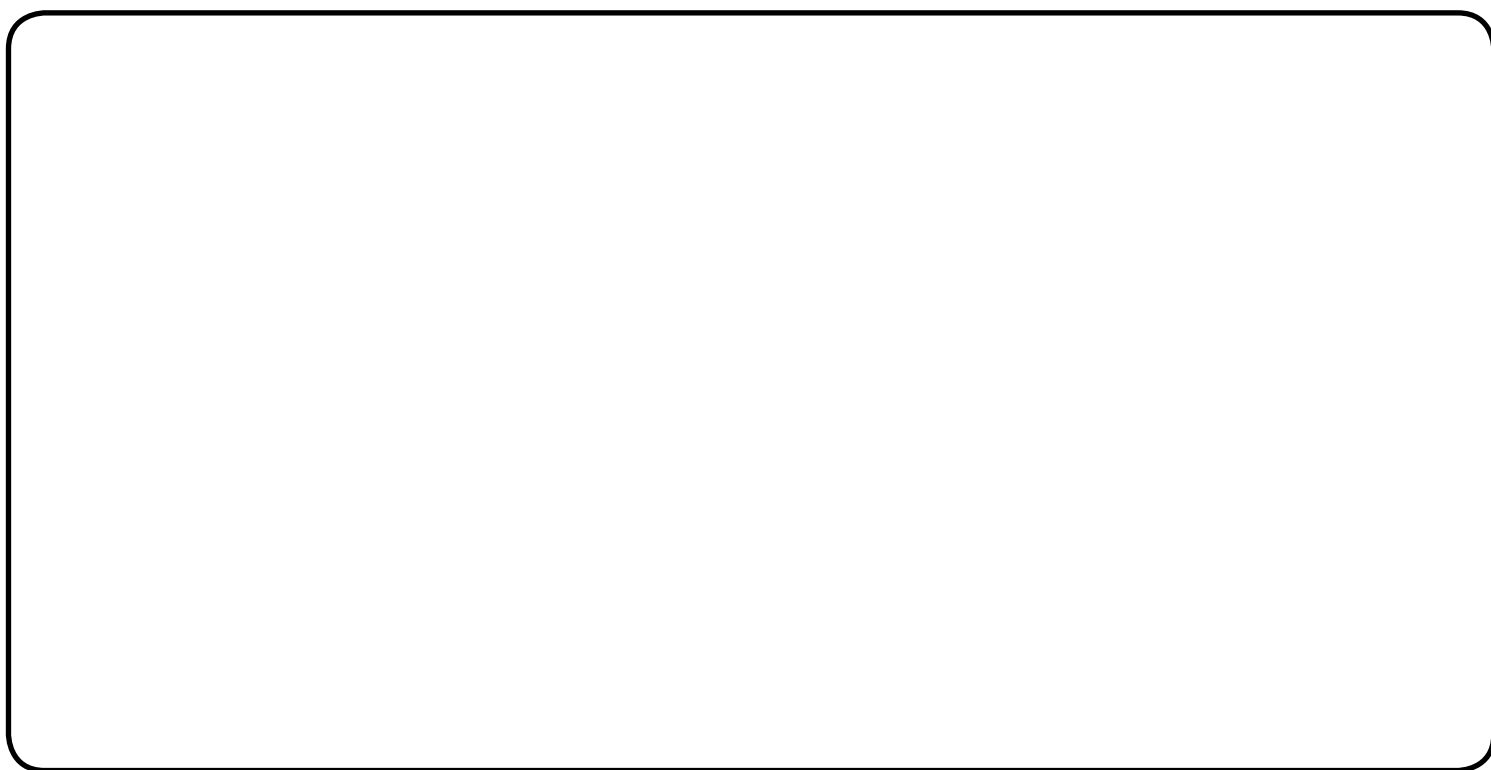

## INSTALLATION INSTRUCTIONS

### Yamaha Grizzly 660 Power Steering

Item	Description	Qty
A	M8-1.25 x 20mm Lg. Hex Flange Bolts	3
C	M6-1.0 x 16mm Lg. HHCS	2
D	Stiffener	1
E	Support Bracket	1
F	M6-1.0 x 40mm Lg. HHCS	2
G	Upper Shaft	1
H	Lower Shaft	1
J	Control Module	1
K	Motor	1
L	Wiring Harness	1
M	Wiring Connectors Kit	1
N	Mounting Bracket	1
P	Control Module Mounting Bracket	1
Q	M6 Flat Washers	4
R	M6-1.0 Nylock Nuts	2
S	M8-1.25 x 25mm Lg. HHCS	4
T	M8 Flat Washers	7
U	M8-1.25 Nylock Nuts	3

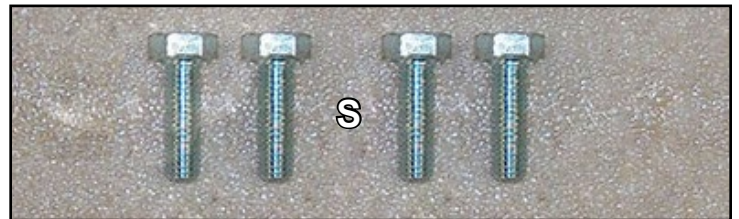
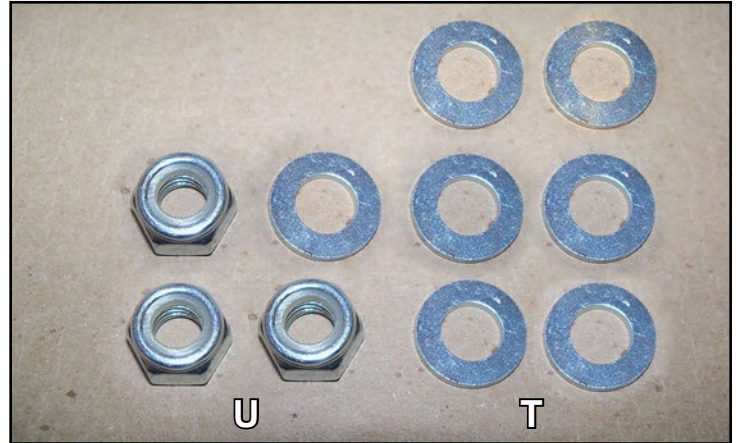

(Kit contents continue on following page)



**Read instructions and view illustrations before beginning.**

**Need help with your installation?**



sales@superatv.com



www.superatv.com



1-812-574-7777



8:00am - 9:00pm EST M-Th  
8:00am - 7:00pm EST Friday  
9:00am - 2:00pm EST Saturday

*Thank You  
For Choosing*

#### Liability Statement

SuperATV's products are designed to best fit users ATV/UTV under stock conditions. Adding, modifying, or fabricating any factory, or aftermarket, parts will void any warranty provided by SuperATV and is not recommended. SuperATV's products could interfere with other aftermarket accessories. If user has aftermarket products on machine, contact SuperATV to verify that they will work together.

Although SuperATV has thousands of satisfied customers, user should be aware that installing lift kits, long travel, or suspension kits, tires, etc will change the ride of machine and may increase maintenance and part wear. Operating any off-road machine while, or after, consuming alcohol and/or drugs increases risk of bodily harm or death. No warranty or representation is made as to this product's ability to protect user from severe injury or death. SuperATV urges operators and occupants to wear a helmet and appropriate riding gear at all times.

By purchasing and installing SuperATV products, user agrees that should damages occur, SuperATV will not be held responsible for loss of time, use, labor fees, replacement parts, or freight charges. SuperATV, nor any 3rd party, will not be held responsible for any direct, indirect, incidental, special, or consequential damages that result from any product purchased from SuperATV. The total liability of seller to user for all damages, losses, and causes of action, if any, shall not exceed the total purchase price paid for the product that gave rise to the claim.

SuperATV will warranty only parts provided by SuperATV. Any damage or problems with OEM housings, bearings, seals, or other manufacturers products will not be covered by SuperATV. SuperATV parts and products are not warranted if item was not installed properly, misused, or modified.

Item	Description	Qty
A	M8-1.25 x 20mm Lg. Hex Flange Bolts	3
C	M6-1.0 x 16mm Lg. HHCS	2
D	Stiffener	1
E	Support Bracket	1
F	M6-1.0 x 40mm Lg. HHCS	2
G	Upper Shaft	1
H	Lower Shaft	1
J	Control Module	1
K	Motor	1
L	Wiring Harness	1
M	Wiring Connectors Kit	1
N	Mounting Bracket	1
P	Control Module Mounting Bracket	1
Q	M6 Flat Washers	4
R	M6-1.0 Nylock Nuts	2
S	M8-1.25 x 25mm Lg. HHCS	4
T	M8 Flat Washers	7
U	M8-1.25 Nylock Nuts	3

(Kit contents continued)

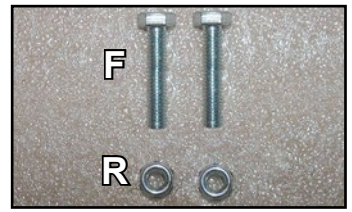
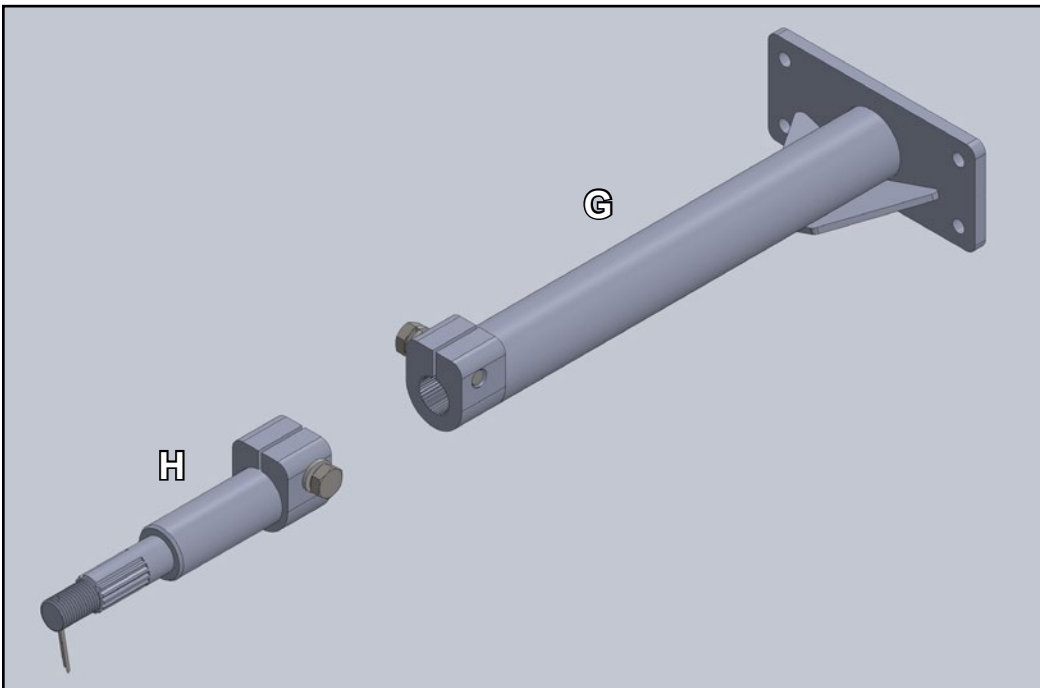
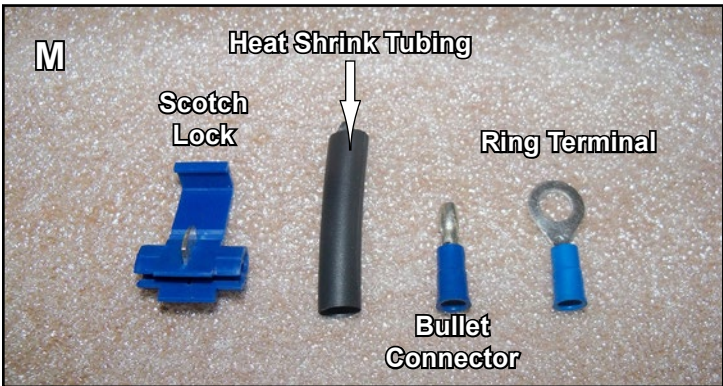
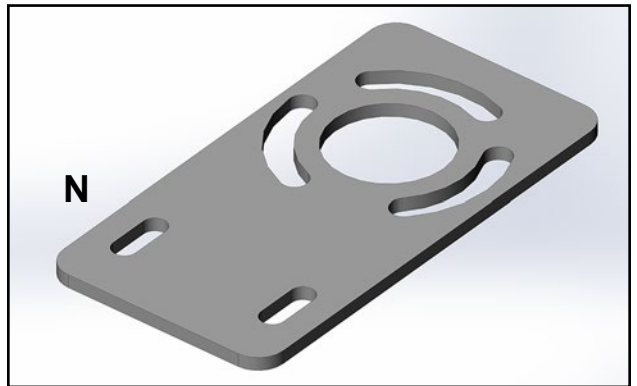
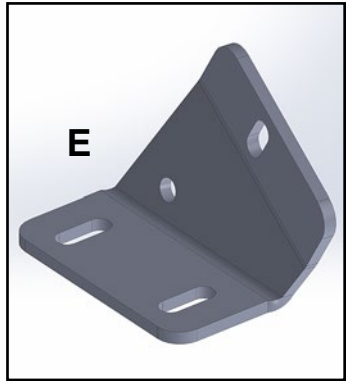
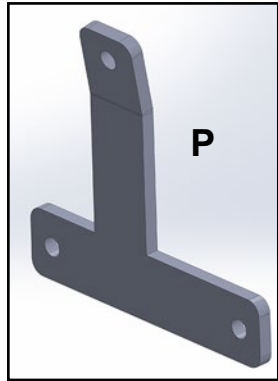
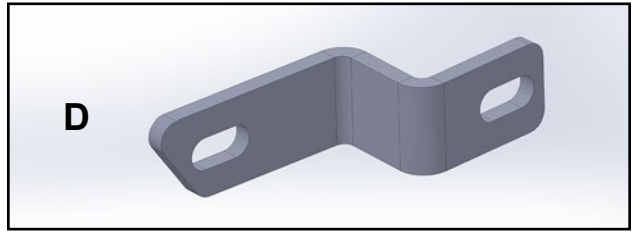



## Connections

- Before installing, ensure that all waterproof connections are properly seated.
- If Gaskets are not seated, as shown, use a Flathead Screwdriver to seat.

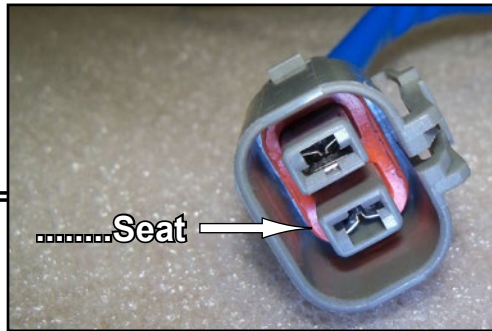
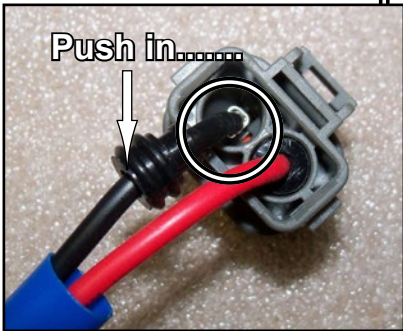
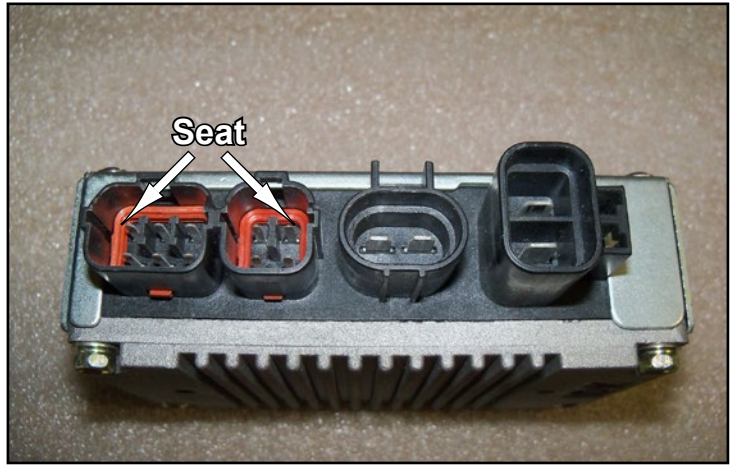
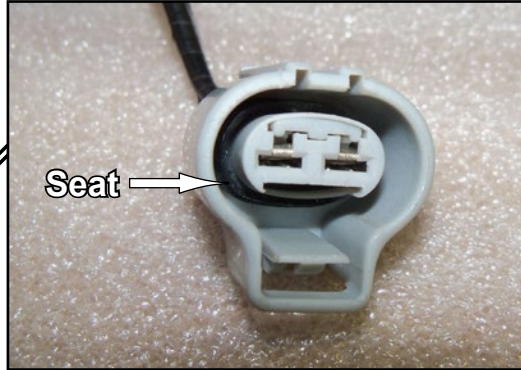



For reference, photographing of removal process is highly recommended due to amount of components being removed from machine.

**Removal:** *Keep all stock hardware removed from machine.*

1. Raise front of machine, secure with jack stands; and remove Wheels.
2. Remove Tie Rods. See Fig. 1.
3. Remove Nut Washer, and Pin from Steering Shaft. See Figs. 1 - 1a.
4. Remove Seat.
5. Remove Cargo Rack and Tray. See Figs. 2 - 2a.
6. Remove Side Covers. See Fig. 3.
7. Remove Tank Cover. See Fig. 4.
8. Remove Handlebar Cover and Gauge Pod. See Fig. 5.
9. Remove hardware from Handlebar Holders and Bracket. Lay Handlebar out of way. See Figs. 6 - 6a.
10. Remove Lockwasher, Bracket, Steering Bearings, and Oils Seals from Steering Shaft. See Figs. 7 - 7a.
11. From top of machine pull Steering Shaft out.

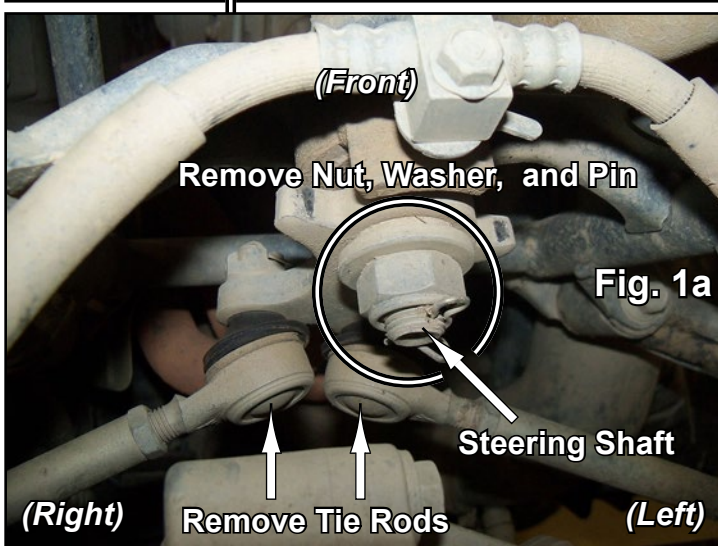
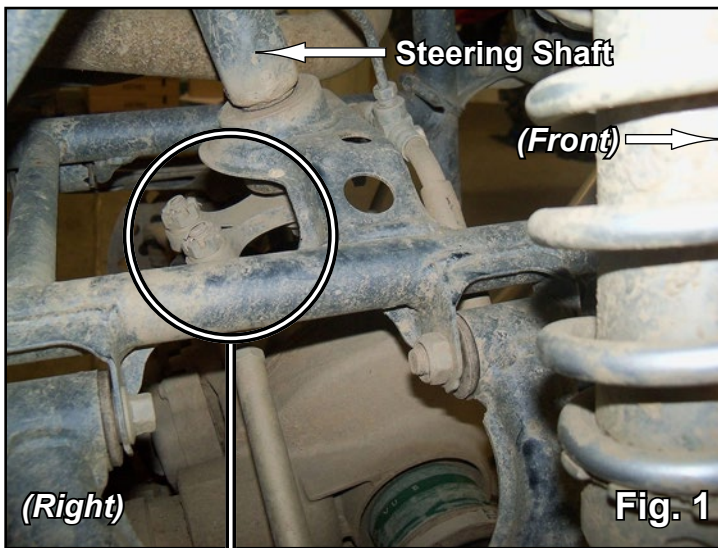



(Removal illustrations continued)

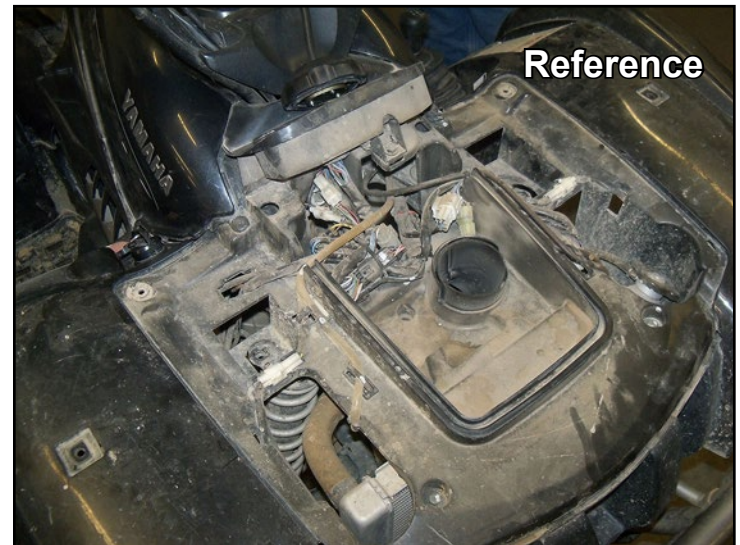
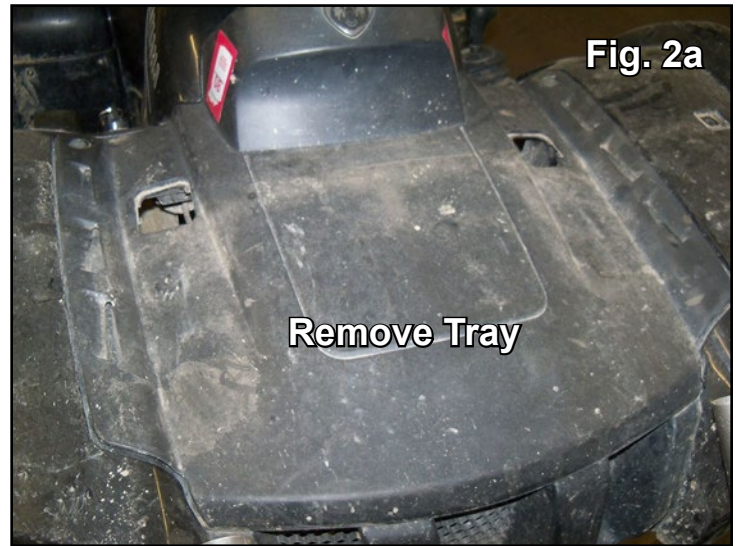

(Removal illustrations on following pages)



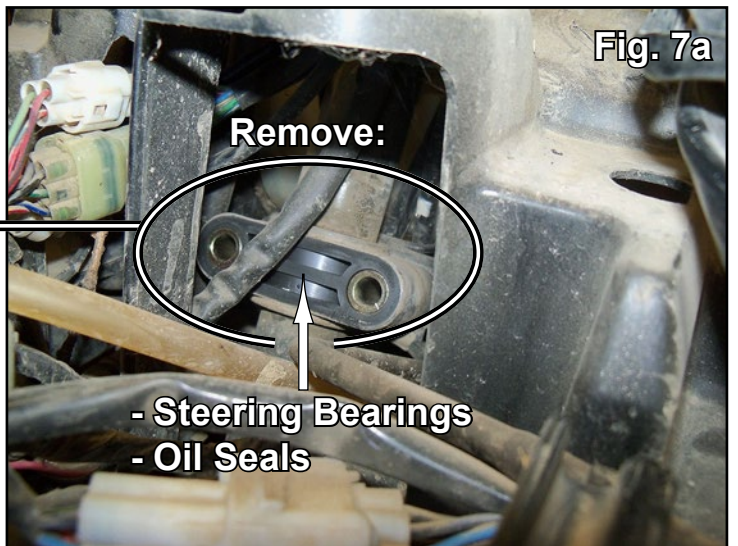
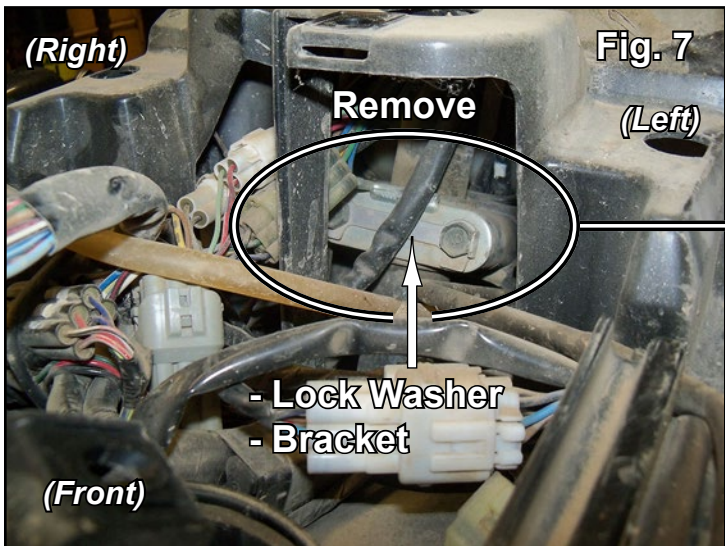
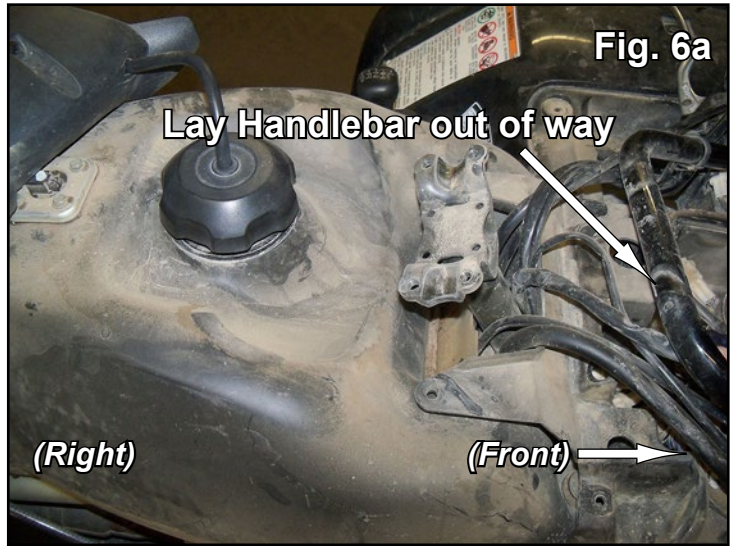
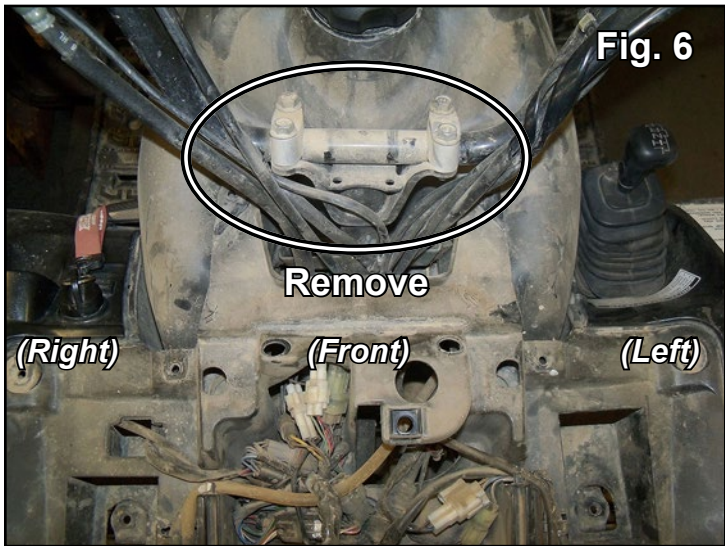



**Do not tighten hardware completely unless noted.**

**Installation:**

1. Install Lower Shaft (H) to stock location. Secure with stock hardware. See Figs. 1 - 1a. Loosely reinstall Tie Rods with stock hardware.
2. Install Motor (K) onto Lower Shaft (H). Secure with provided hardware. See Motor Shafts Detail and Fig. 1.
3. Install Mounting Bracket (N) to Motor (K) with M8-1.25 x 20mm Lg. Hex Flange Bolts (A). See Figs. 2 - 2b.
4. From top of machine, install Upper Shaft (G) to Motor (K). Secure to Motor (K) with provided hardware. See Figs. 2 and 3a.
  - Reinstall Lockwasher, Bracket, Steering Bearings, Oil Seals, Upper Shaft (G) to Frame with stock hardware. See Fig. 3b.
5. Install Support Bracket (E) to Mounting Bracket (N) with M8-1.25 x 25mm Lg. HHCS (S), M8 Flat Washers (T), and M8-1.25 Nylock Nuts (U). See Figs. 4 - 4a.
  - Secure Support Bracket (E) to Frame with M6-1.0 x 40mm Lg. HHCS (F), M6 Flat Washers (Q), and M6-1.0 Nylock Nut (R). See Figs. 4 - 4a.
6. Locate Selector Bracket, as shown in Fig. 5, and remove stock Bolt. Install Stiffener (D) with stock Bolt. See Figs. 5 - 5b.
  - Install opposite end of Stiffener (D) to Support Bracket (E) with M8-1.25 x 25mm Lg. HHCS (S), M8 Flat Washers (T), and M8-1.25 Nylock Nut (U). See Figs. 5 - 5b.
7. On right side of machine, install M6 Flat Washer (Q) and M6-1.0 x 40mm Lg. HHCS (F) as shown in Fig. 6.
  - Install Control Module/Bracket Assembly (J)(P) and secure with M6 Flat Washer (Q), and M6-1.0 Nylock Nut (R). See Figs. 6 - 6b.
  - Plug in Wire Harness (L) but do not wire.

**Handlebar should be inline with Tie Rods before tightening hardware. Lift Handlebar up and off of Motor (K) and realign if not.**

8. Reinstall Handlebar Holders, Bracket, and Handlebar with stock hardware.
9. Make wire connections. See Wiring Details pages 13 - 14.
10. Tighten all hardware completely.
11. Reverse steps taken during "Removal" and reinstall components.

Pre assemble Control Module (J) to Control Module Mounting Bracket (P) with M6-1.0 x 16mm Lg. HHCS (C).

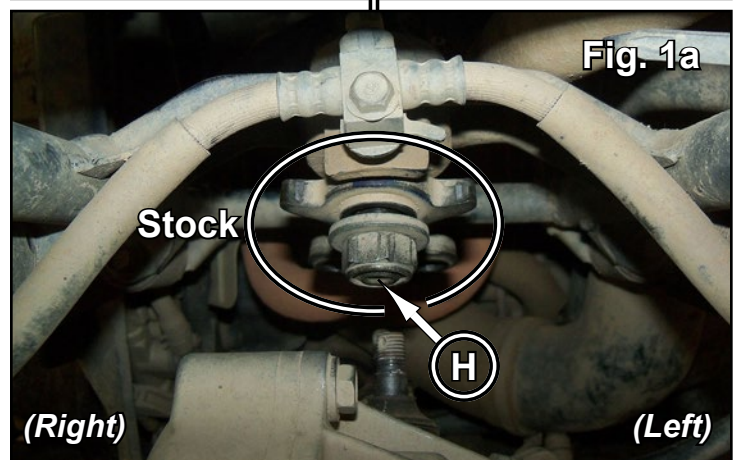
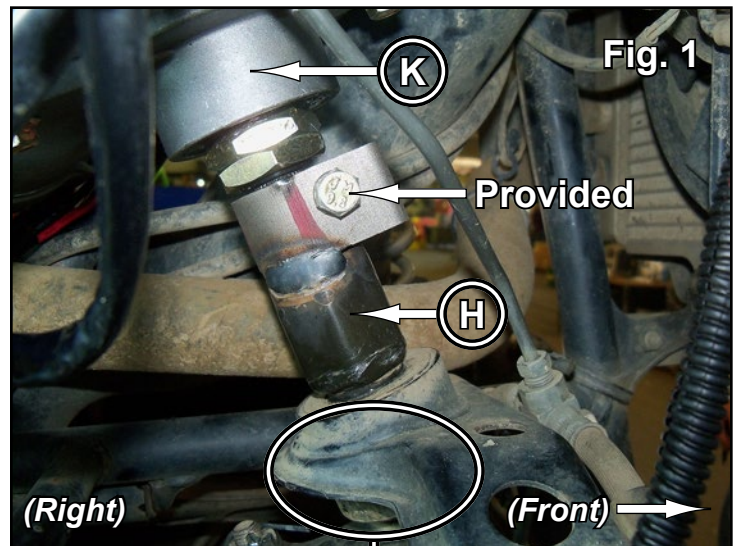
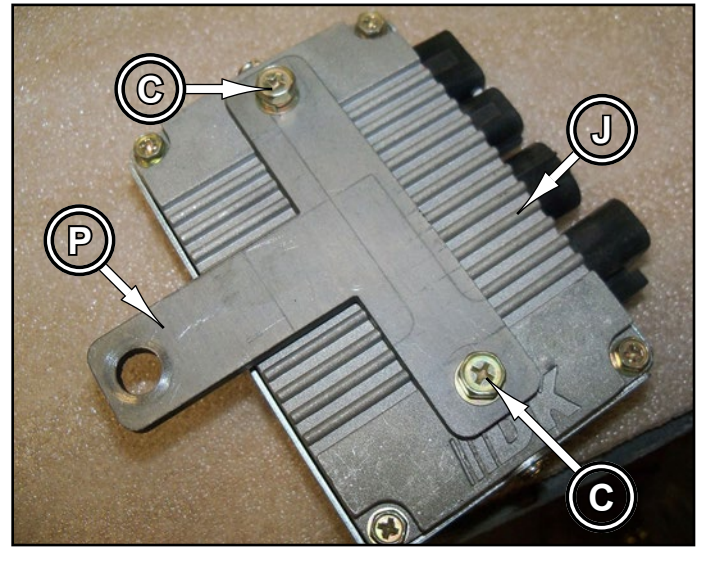

*(Installation illustrations on following page)*



**Motor Shafts Detail**

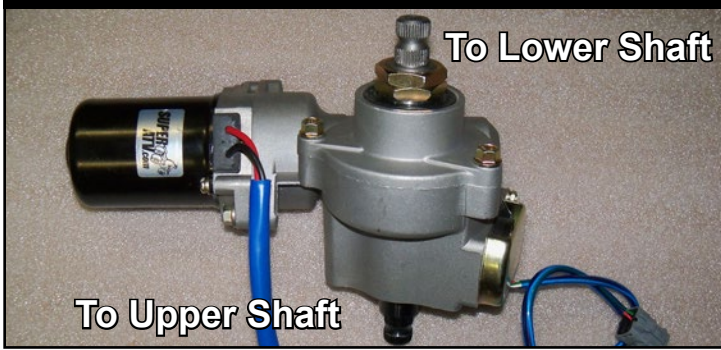

*(Installation illustrations continued)*

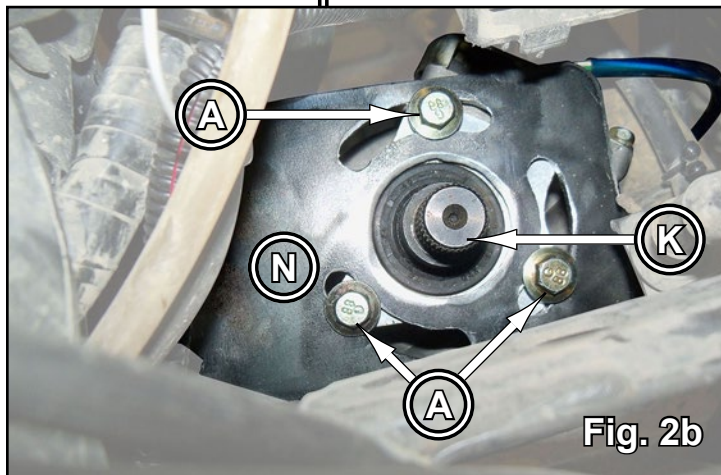
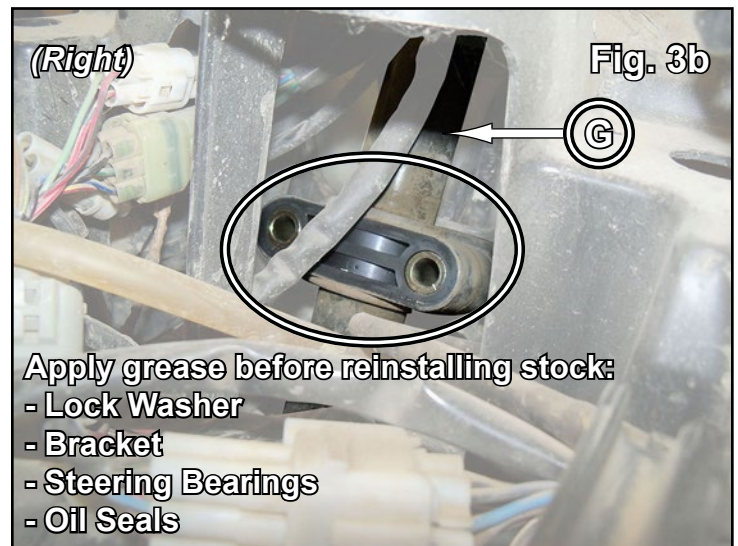
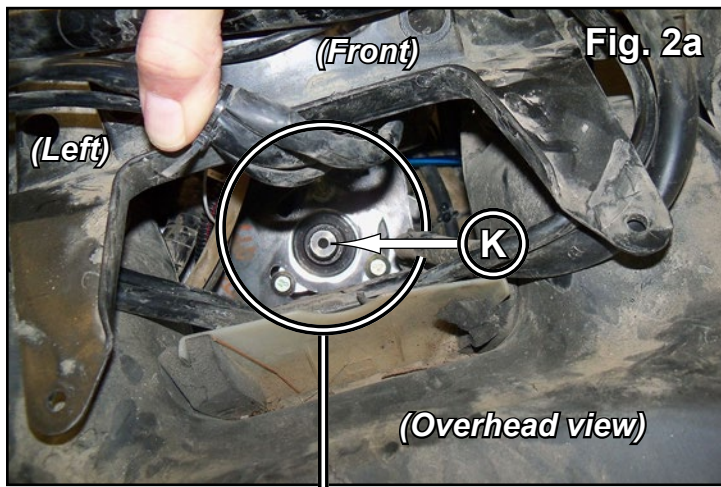
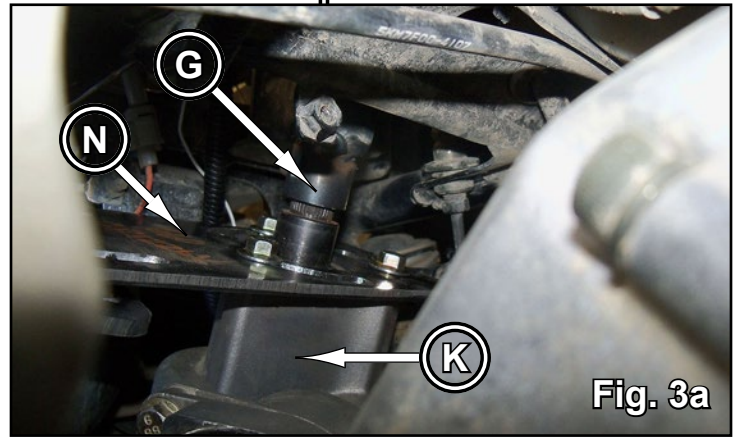
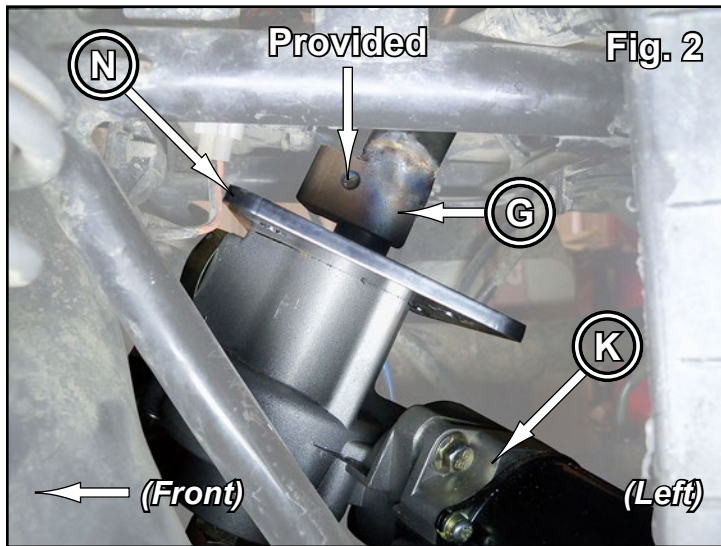
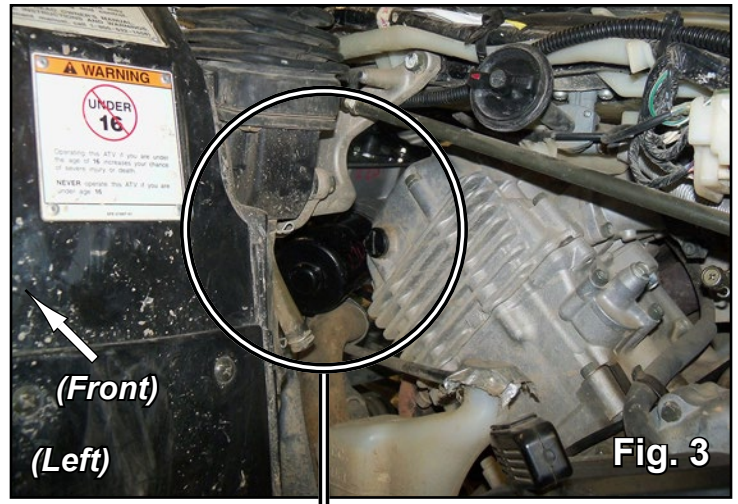



(Installation illustrations continued)

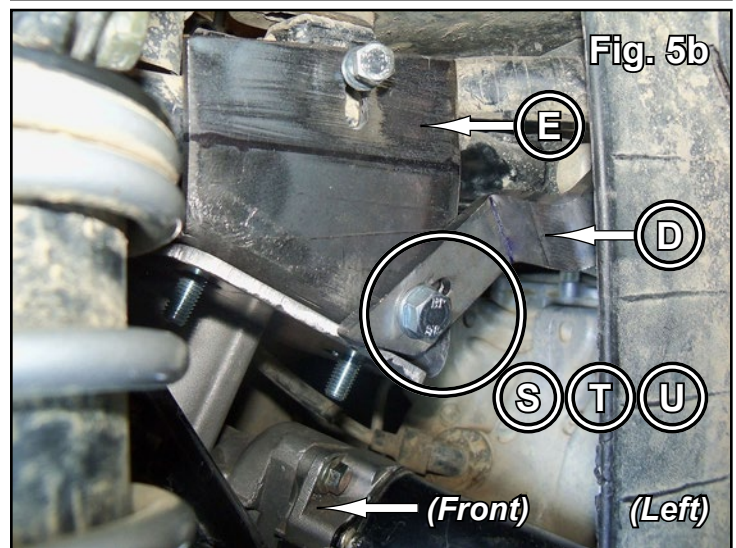
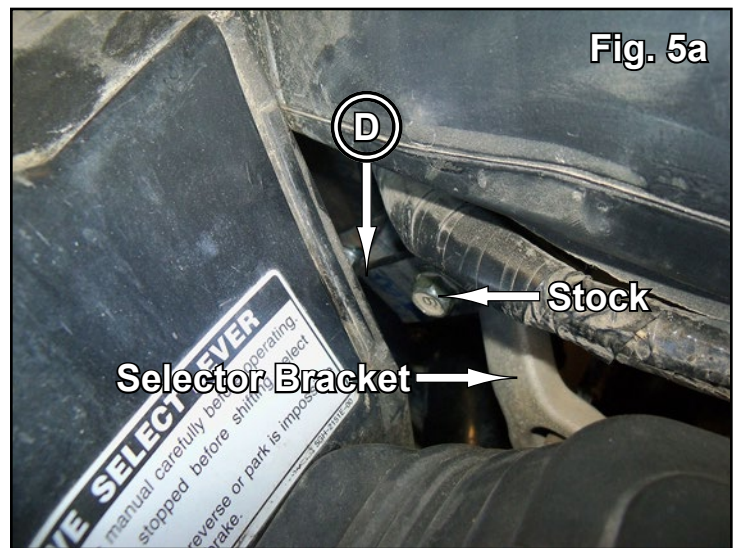
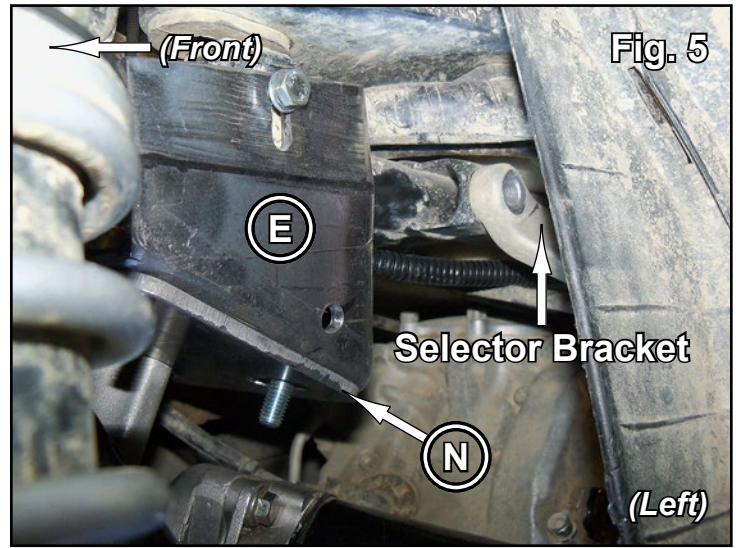
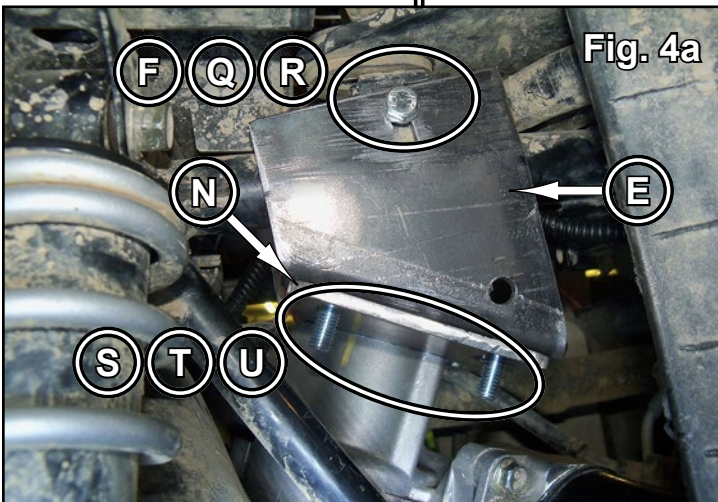
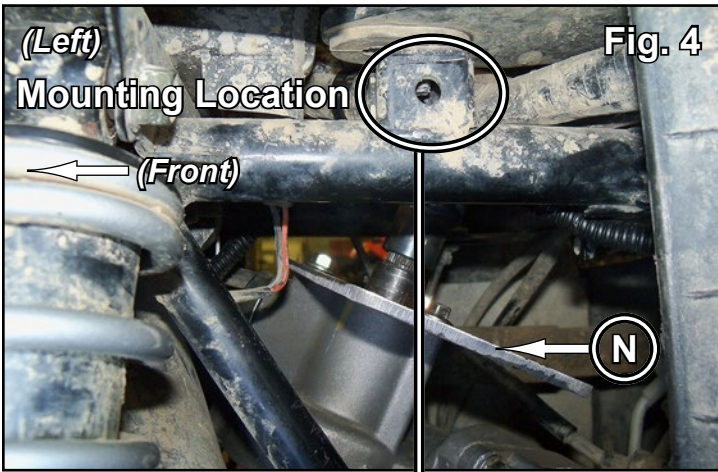

### PARTS REFERENCE

Item	Description
A	M8-1.25 x 20mm Lg. Hex Flange Bolts
C	M6-1.0 x 16mm Lg. HHCS
D	Stiffener
E	Support Bracket
F	M6-1.0 x 40mm Lg. HHCS
G	Upper Shaft
H	Lower Shaft
J	Control Module
K	Motor
L	Wiring Harness
M	Wiring Connectors Kit
N	Mounting Bracket
P	Control Module Mounting Bracket
Q	M6 Flat Washers
R	M6-1.0 Nylock Nuts
S	M8-1.25 x 25mm Lg. HHCS
T	M8 Flat Washers
U	M8-1.25 Nylock Nuts

(Installation illustrations on following page)



(Installation illustrations continued)

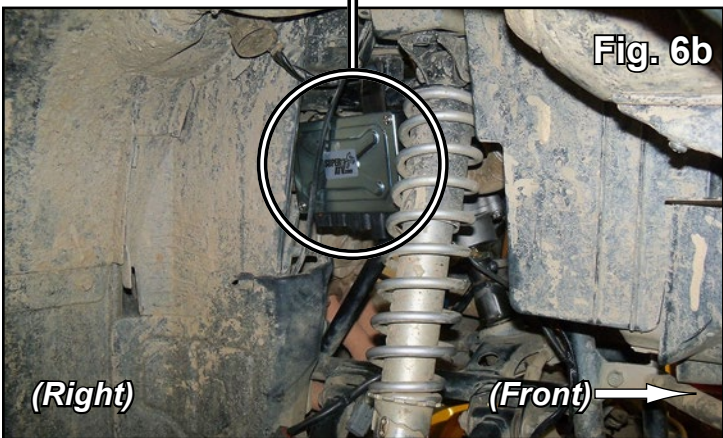
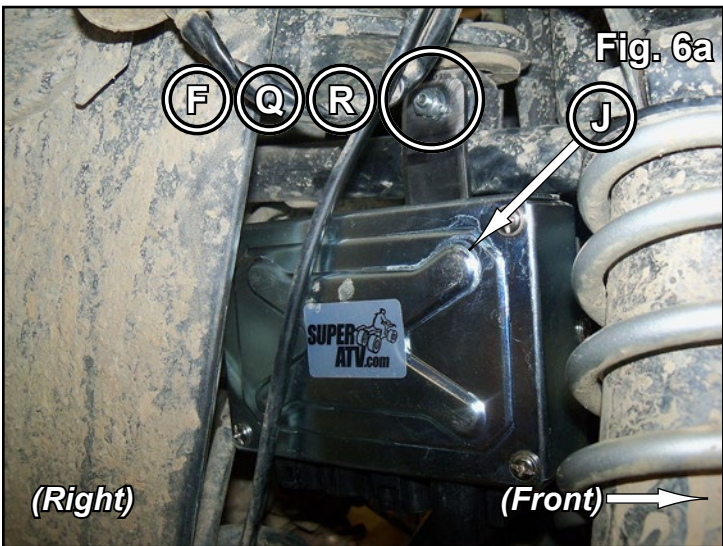
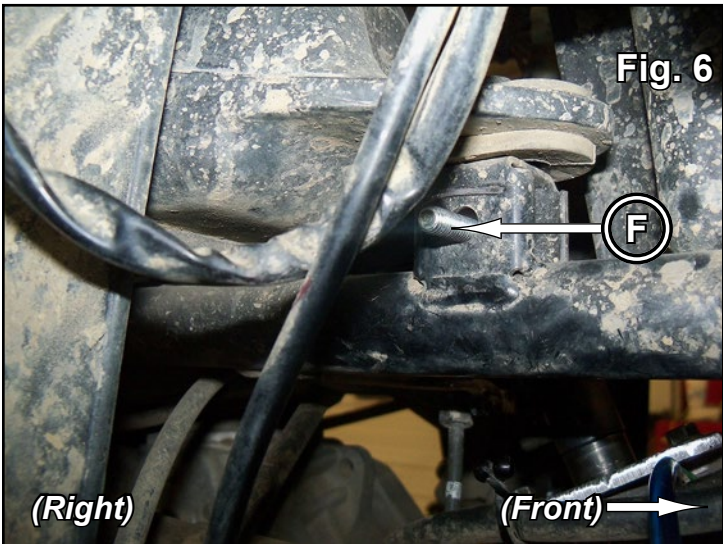

## PARTS REFERENCE

Item	Description
A	M8-1.25 x 20mm Lg. Hex Flange Bolts
C	M6-1.0 x 16mm Lg. HHCS
D	Stiffener
E	Support Bracket
F	M6-1.0 x 40mm Lg. HHCS
G	Upper Shaft
H	Lower Shaft
J	Control Module
K	Motor
L	Wiring Harness
M	Wiring Connectors Kit
N	Mounting Bracket
P	Control Module Mounting Bracket
Q	M6 Flat Washers
R	M6-1.0 Nylock Nuts
S	M8-1.25 x 25mm Lg. HHCS
T	M8 Flat Washers
U	M8-1.25 Nylock Nuts

Power Steering will provide multiple improvements to your machine. After installation, it is highly recommend to take time and learn your machines new handling characteristics and feel.

### Key Recommendations:

1. Power Steering Benefits will be noticed as soon as machine is moving.
2. Handlebar will have more noticeable deflection while at rest. As a result of speed sensitive operation, this is normal.
3. Check steering sensitivity at multiple speeds to best understand new handling characteristics and feel.
4. Without Throttle input, turning Handlebar back and forth unnecessarily is not recommended. This action is very hard on remaining stock steering components, Tie Rod Ends, and Power Steering unit.

Like all SuperATV products, Power Steering kits were designed with riders in mind.



## Wiring Details

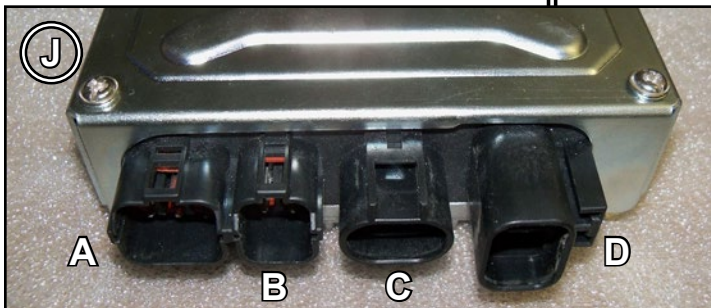
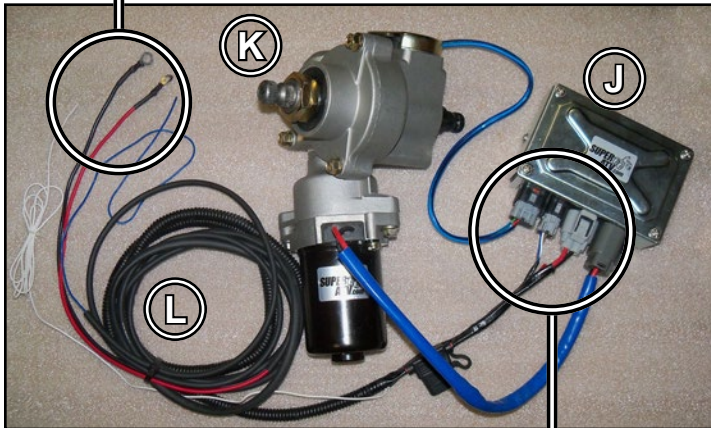
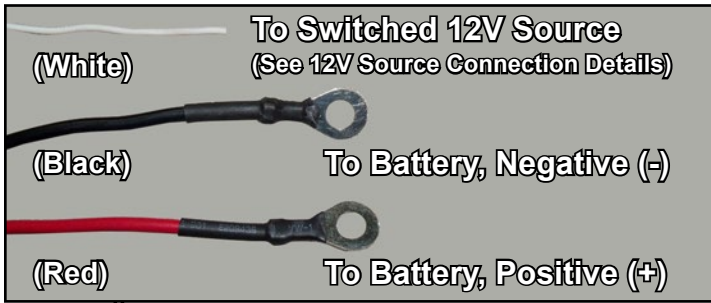

Plug	Function
A	Torque Sensor
B	Switched 12V Source
C	Power
D	Motor

When activated, Diagnostic Light will flash (1) time for about (1) second before turning off indicating proper function. Should different patterns occur, contact SuperATV.

Secure Diagnostic Light in a visible location.

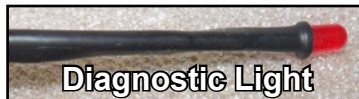

## Battery Connections

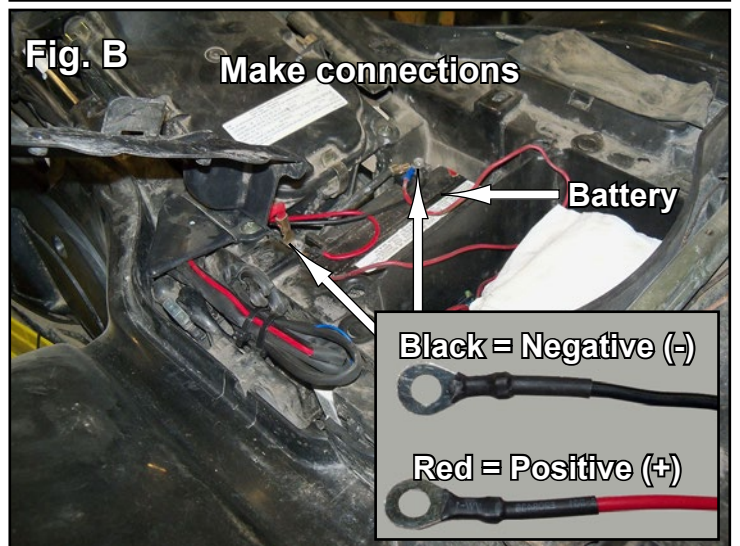
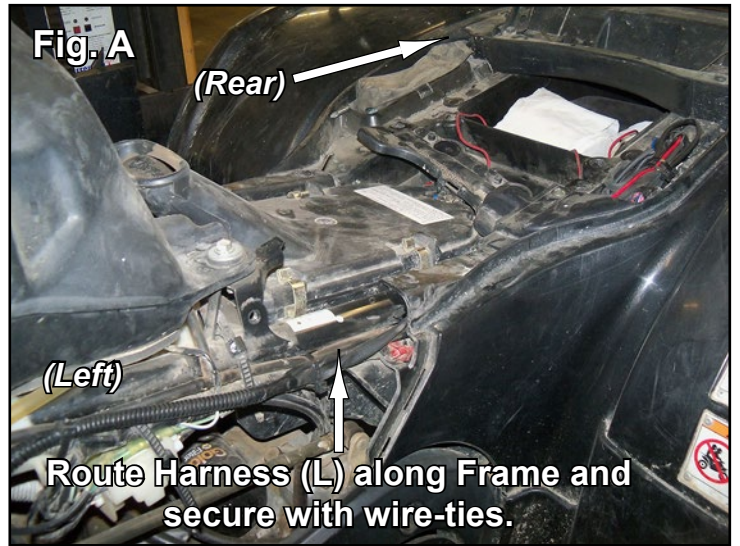

1. Route wires to rear of machine as shown in Fig. A.
2. Connect wires to Battery as shown in Fig. B.

**⚠ Disregard Blue Wire if present in Wire Harness (L).**

## Wiring Details, continued

### Switched 12V Source Connection Details

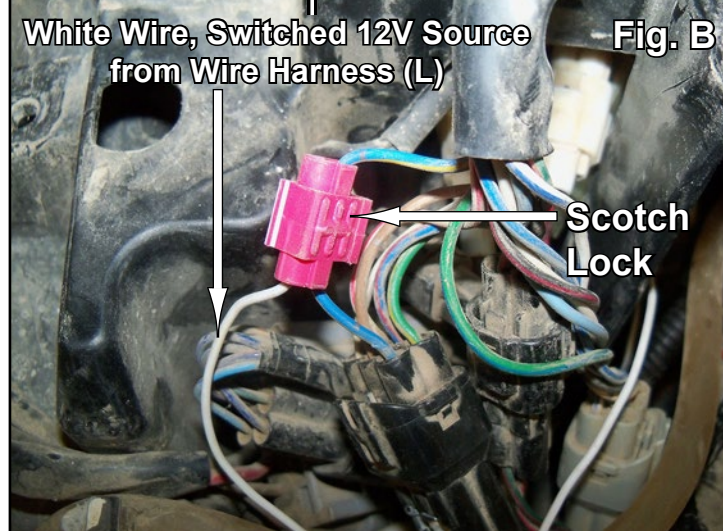
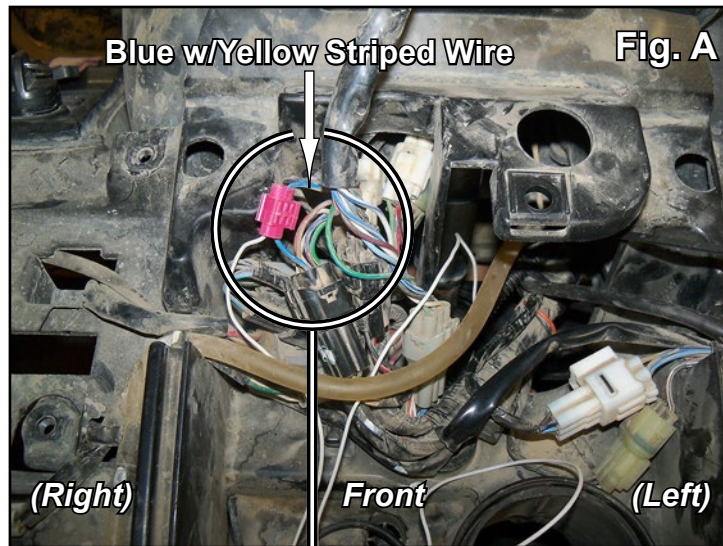

*Soldering connection is recommended however, installer may use other forms of connecting.*

1. Locate Connector shown in Fig. A.
2. Connect White Wire from Wire Harness (L) to Blue with Yellow Striped wire. Scotch Lock (included), Spade Connector (not included), or solder. See Figs. B - C.